



LINES





SCAPE

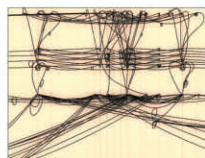

Urban Tracing

Location: Taipei
Advisor: Chang-Hsiu, Lin
2008 Spring



LINESCAPE

Linescape中的空間概念之景透過都市中文化涵構的線條描繪而轉譯建構，用以實踐於台北車站站前新天地廣場及地下街的改造設計案。空間中的線條透過建築性平面描繪詮釋，進而重新轉譯平面線條成為空間模型，一連串的圖像上線條的轉譯都來自自身所在環境涵構裡。此案透過一連串的空間推演與詮釋，建構都市中以線條為主題的人造風景。

RESEARCH

電線與電線杆以交錯纏繞的線條占據巷弄空間，此設計前階段以一條既有巷弄內的電線為觀察描繪對象，清楚理解電線與街道間構成的邏輯秩序，而以其並置後的電線立面作為再發展空間模型的依據。

CONCEPTUAL SCOPE

立面的線被詮釋成面與面的邊緣，面與面則交織成空間，再透過模型製作上材料的選擇，重新形變圖像轉為立體的詮釋。此一過程的結果成為此案的SCAPE，亦為此案的概念性空間模型。

SITE

基地選定於台北車站站前廣場以及地下新天地購物街作為空間演繹的場所，捷運出入口、地下街出入口、地下街採光塔設施構成此區域的複雜性與凌亂性，而地面、B1與B2清楚的剖面層次秩序垂直動線連結性不足亦為此基地特質。

PROGRAM

重新改變垂直向度的層次性以及連結性，以及透過植入的構造物與往來市民作互動為此案的焦點，透過重新設計採光塔整合地下街廣場與垂直動線，以及重塑站前廣場動線的連續性為實質介入的機能。而由都市尺度觀看此構造物，則成為台北車站站前廣場的具有強烈辨識性的標的物。

STUDIO INTRODUCTION

高層國宅 麥當勞 摩天樓群 7-11便利商店 巷道 汽車 地下道 美食 時尚 流行 各牌服飾 垃圾堆 天橋 快車道 交通 股票 政治 報紙 噪音 空氣汙染 廢氣 煙霧 電線杆 路邊小販 塞車 水塔 違章屋頂加蓋 廣告看板 圍籬 牢籠空地 違規停車 電線 加油站 廣播車 擴音喇叭 後巷 天線 夜市 移民 選舉 鐵梯 火車道 計程車 KTV 賓館 公寓 街屋 電視機 冷氣機 公車 電動玩具 速食店 電梯 流浪漢 房地產 公路高架橋 街燈 旅店 號誌燈 流動攤販 公園 廣場 屋頂花園 行動電話 電台 百貨公司 鐵窗 廣告傳單

世界上每一個地方都呈現許多特質，有其正面性，也有負面性；再嘗試分辨和描述其特質中，我們是否對於自己所處的這個既熟悉又陌生的城市有足夠深刻的了解？我們是否經常忽略了身邊顯而易見的事物？而我們又能夠在當中發現什麼？

課程目標

希望以此實驗過程來重新檢視我們的環境，也開始對都市，社會文化，與空間建立更深層體驗；從而，培養自我獨立判斷與觀察記錄方法。

課程說明

課程將分為兩階段，前階段是對都市的蒐證與建立其描述性的模型，完成展演空間的雛形，後階段是尋找真實基地植入，成為一整體的都市空間演繹。



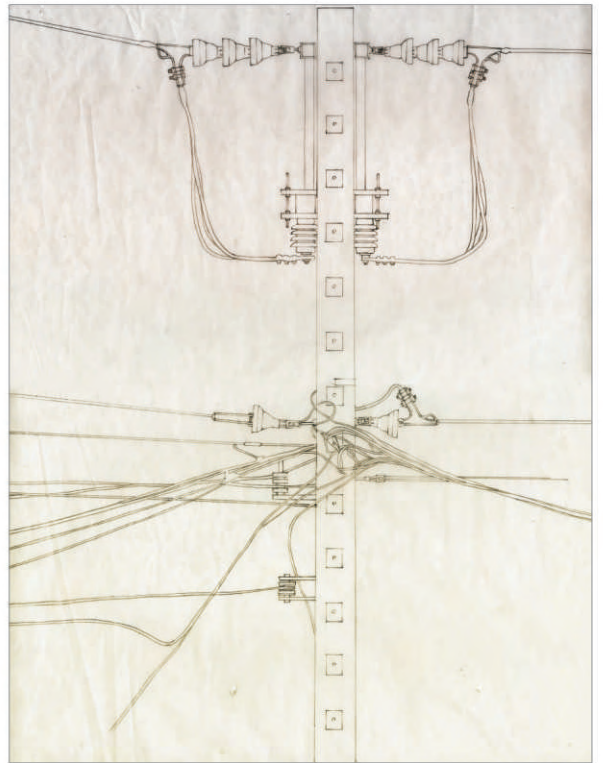

"All photographs are there to remind us of what we forget. In this - as in other ways -- they are the opposite of paintings. Paintings record what the painter remembers. Because each one of us forgets different things, a photo more than a painting may change its meaning according to who is looking at it."

-John Berger





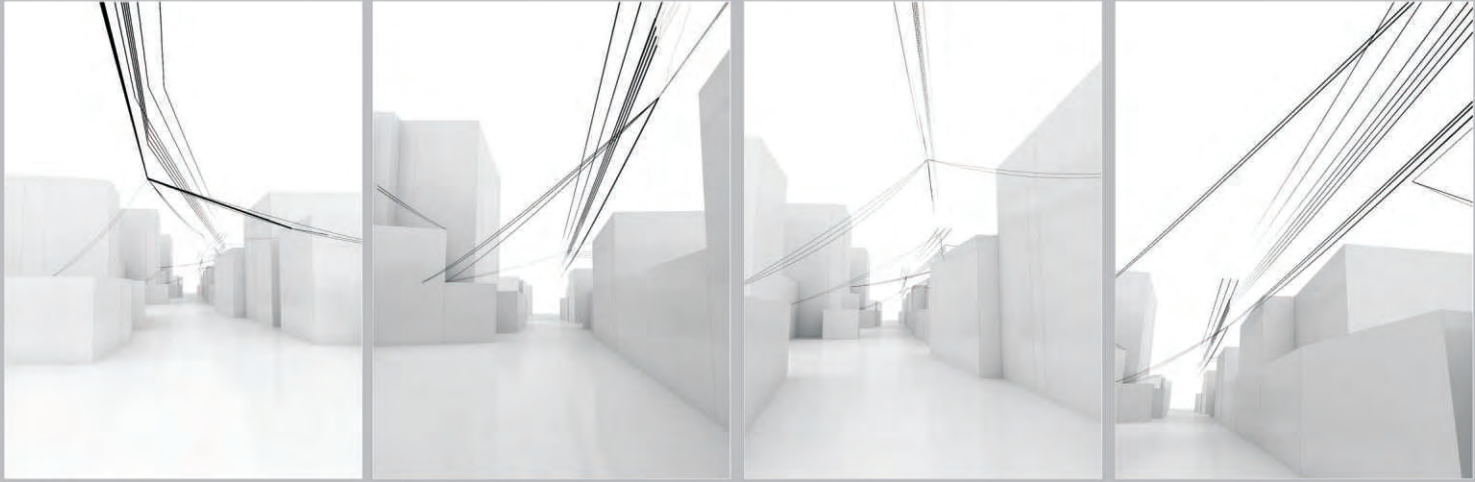

1.7M

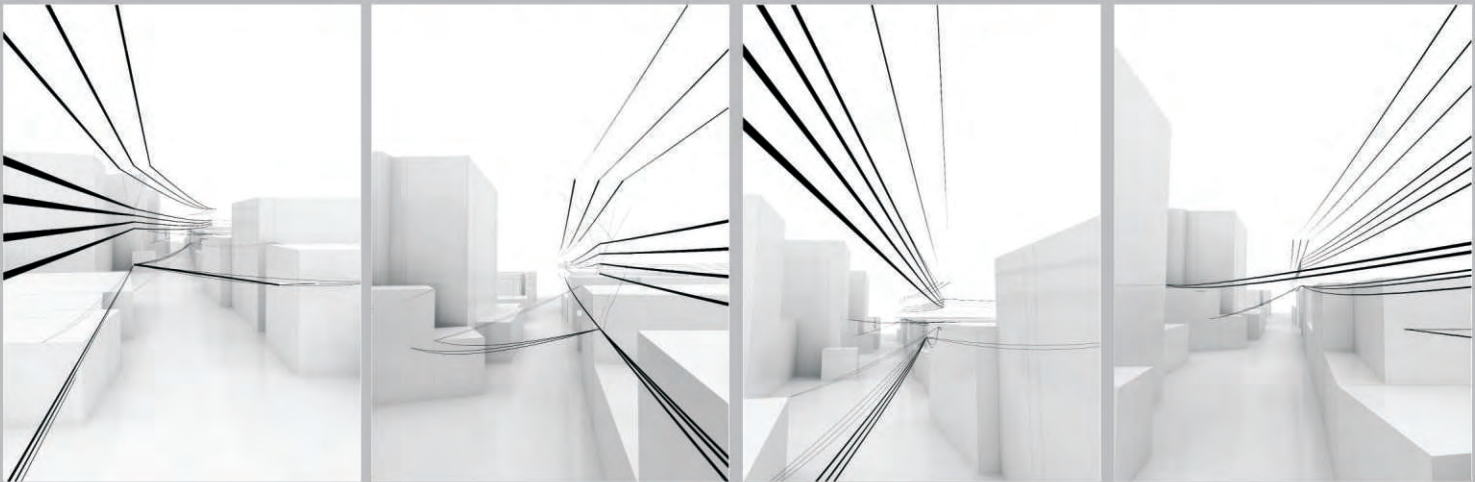
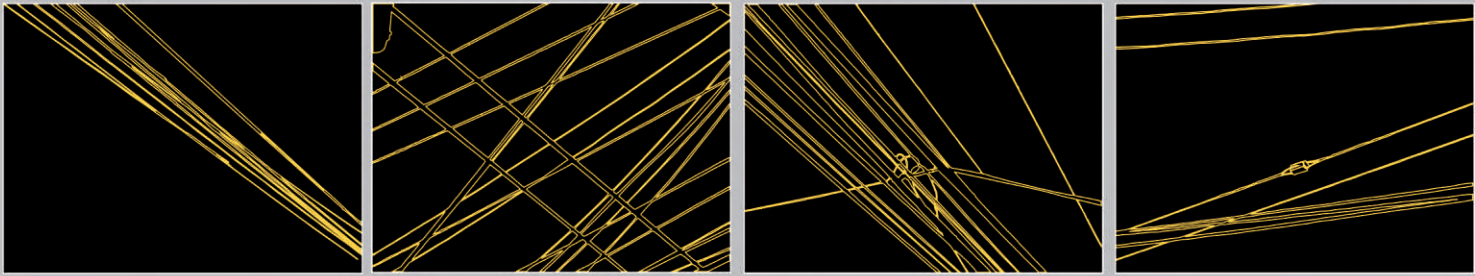

6.6M



F • 211.8M

E • 186.3M

D • 148M

C • 119M

B • 85.6M

A • 0M

WIRES PLAN 



CONCEPTUAL WORKS

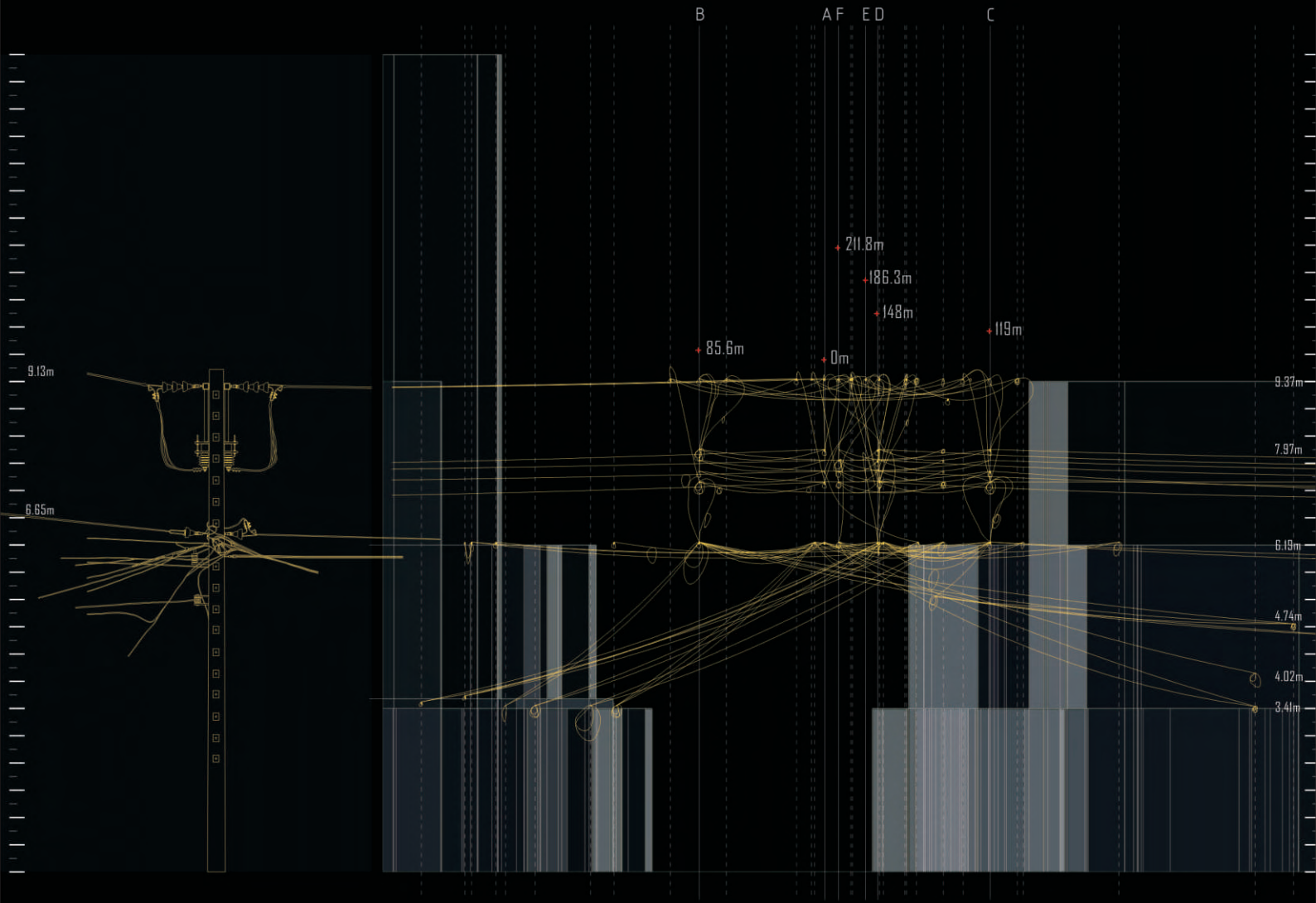

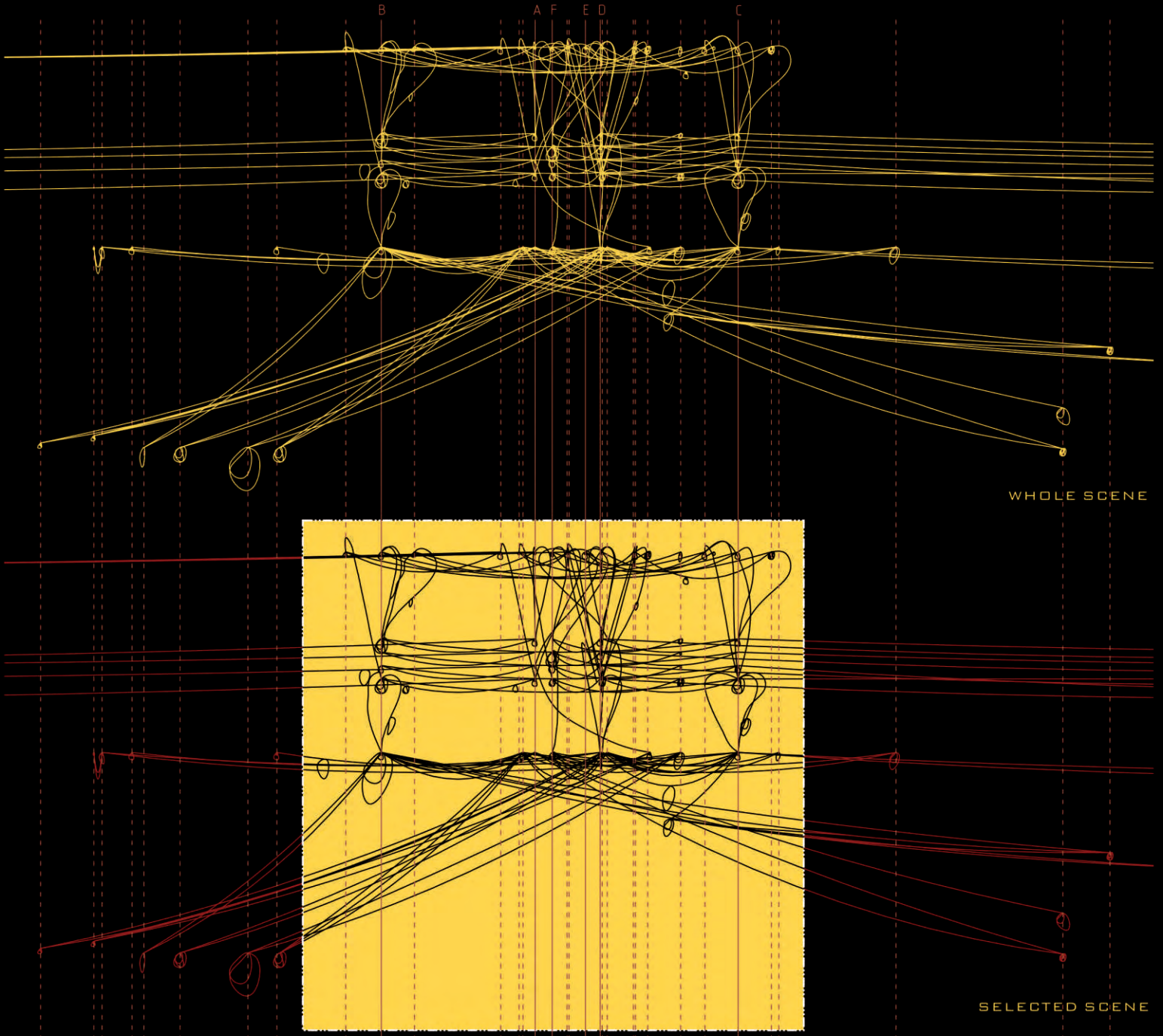

WHOLE SCENE

SELECTED SCENE



EARLY CONCEPTUAL MODEL

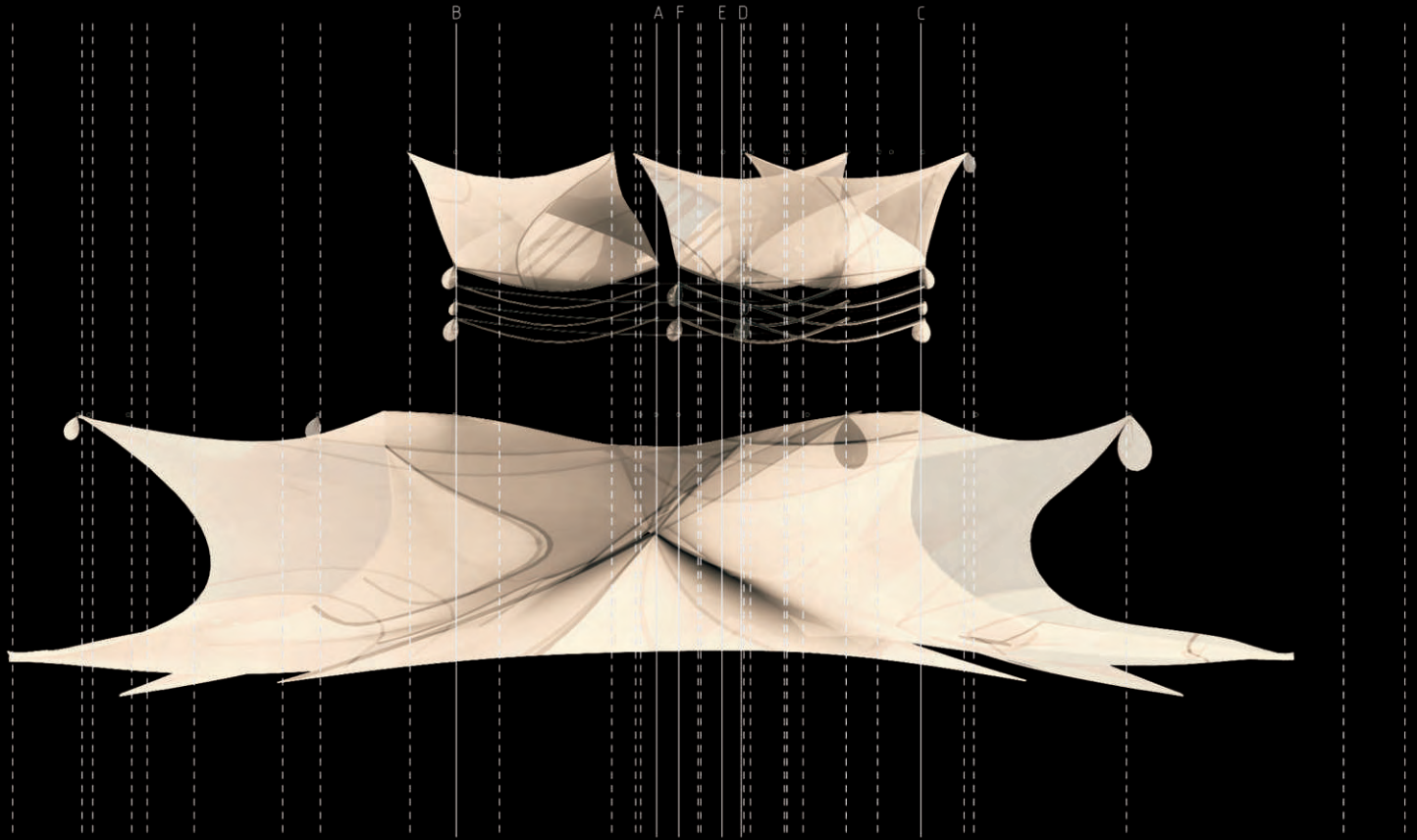

THE JUXTAPOSITION OF SECTIONAL MODEL

HORIZONTAL LINES

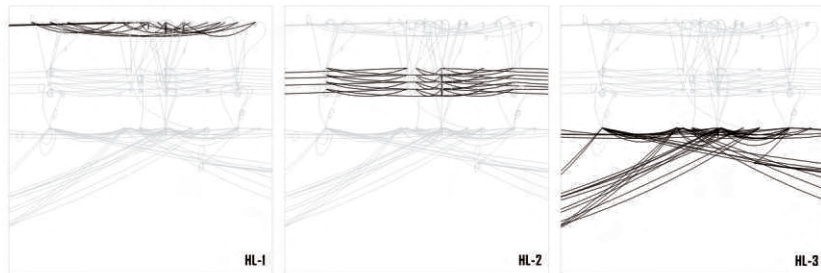

VERTICAL LINES

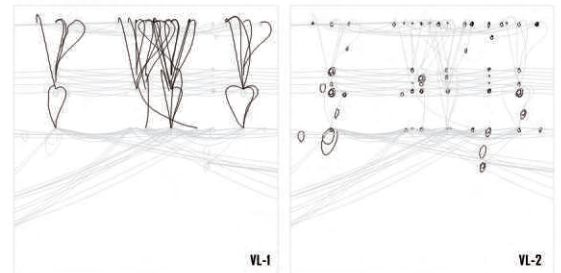

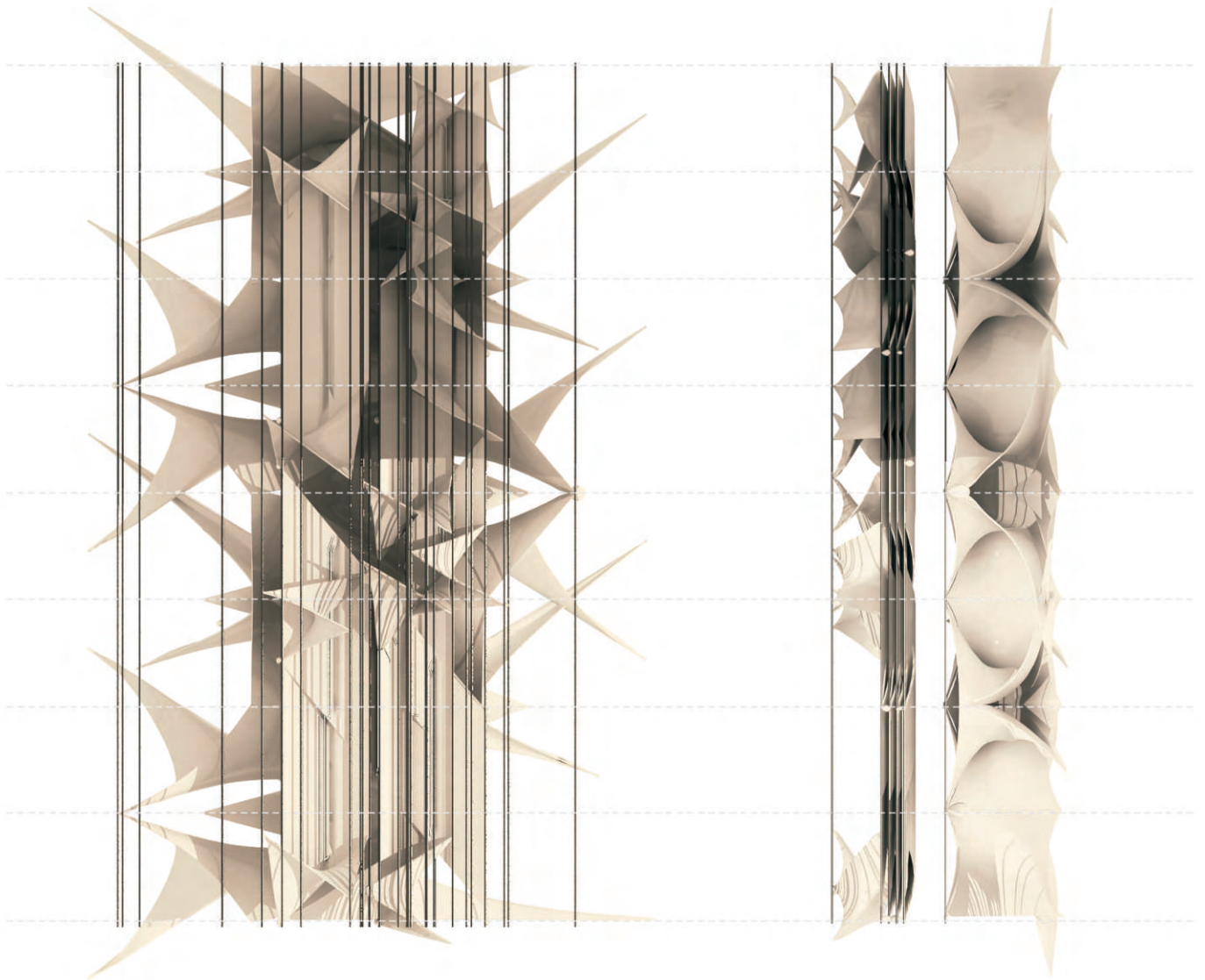

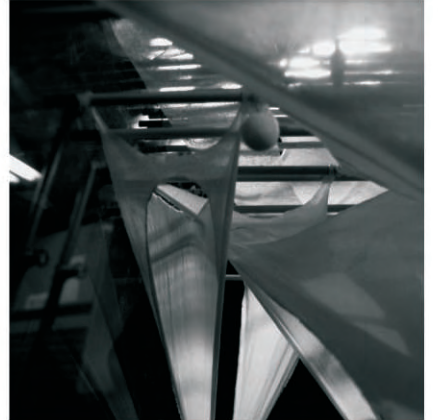
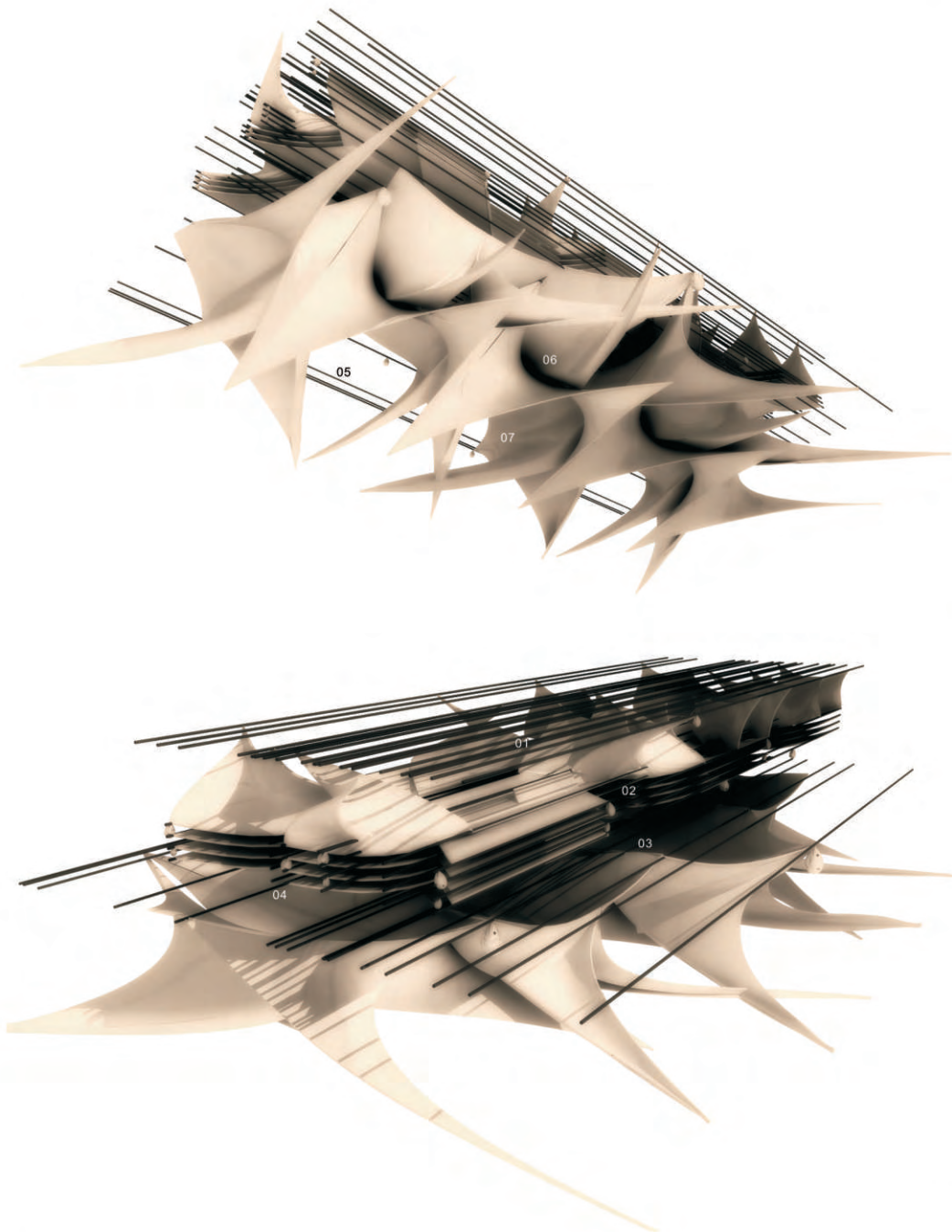

CONCEPTUAL MODEL STUDY



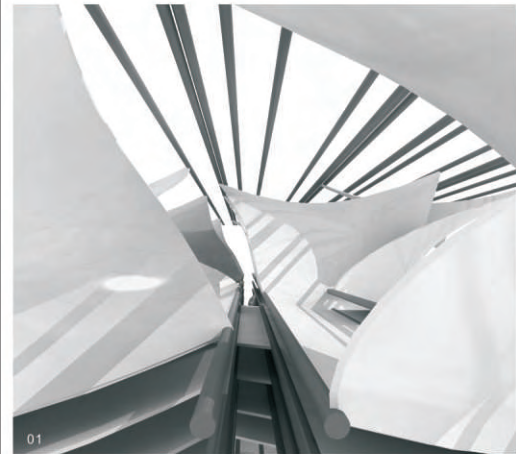

01

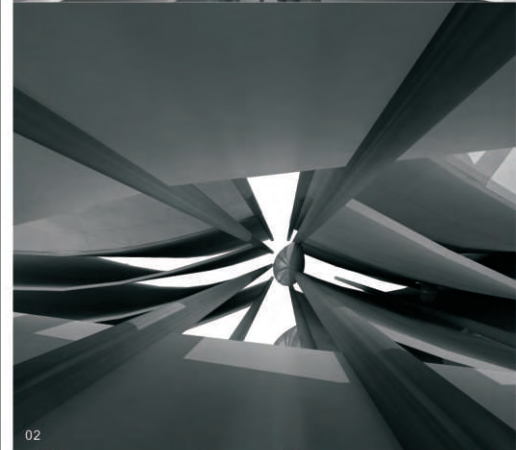

02

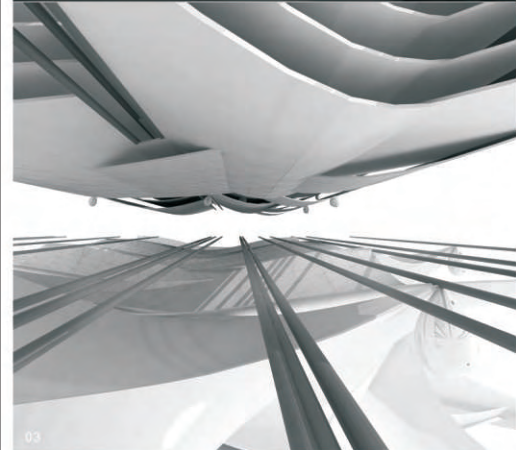

03

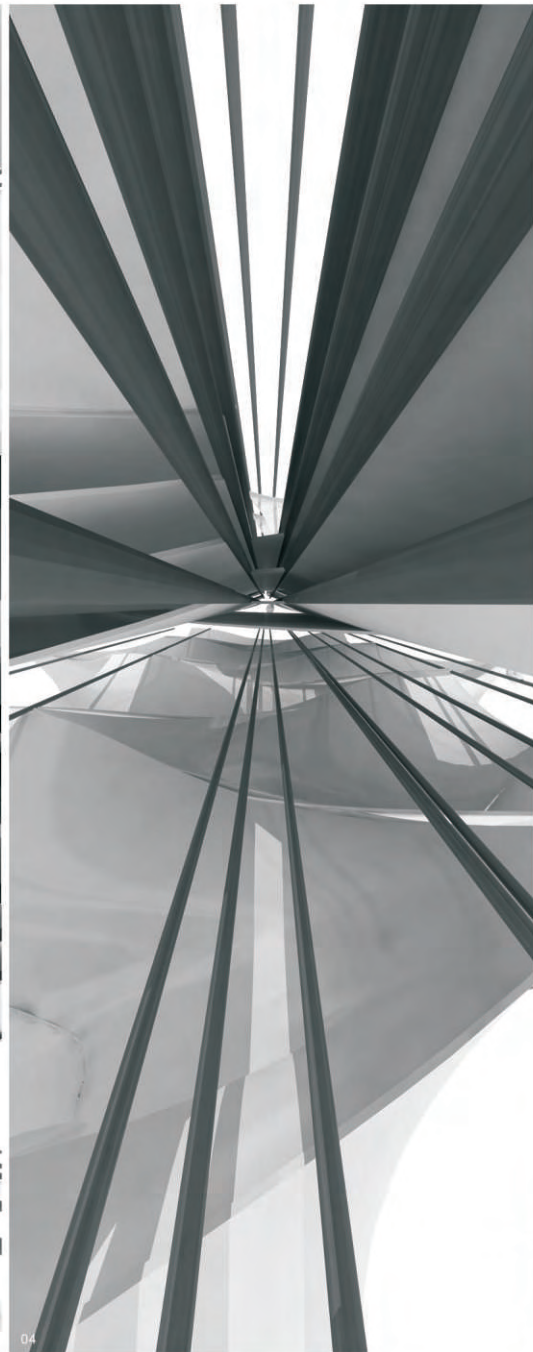

04

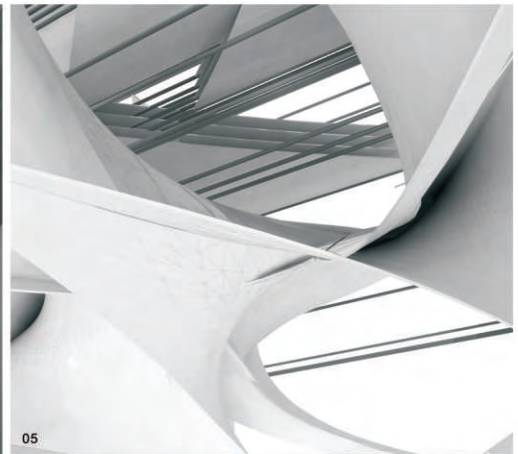

05

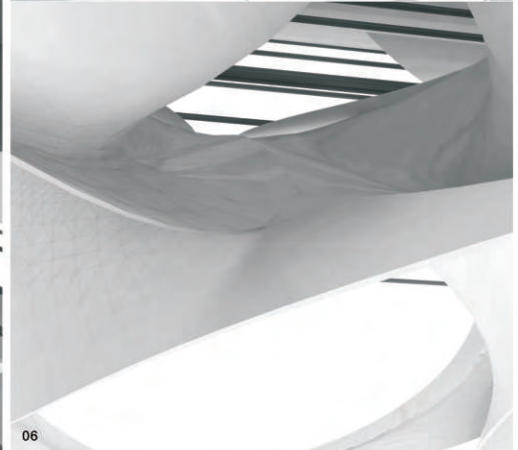

06



07



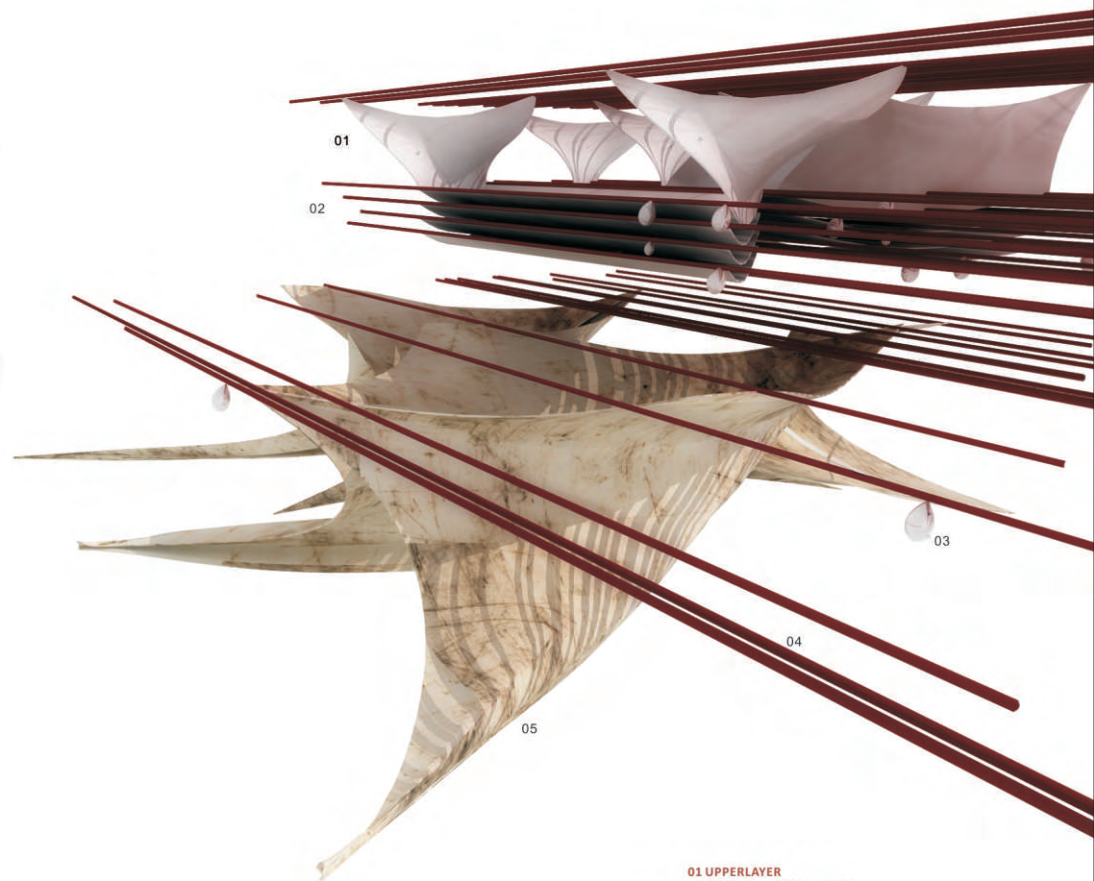

- 01 UPPER LAYER
FRP STRUCTURE
- 02 MIDDLE LAYER
STAINLESS STEEL PLATE
- 03 BALL
GLASS BALL
- 04 STRUCTURE
STAINLESS STEEL TUBE
- 05 LOWER LAYER
CONCRETE STRUCTURE





Civic Blvd.

Zhong-Xiao Western road

Guan-Qian road

- 01. GROUND LEVEL - TAIPEI MAIN STATION PLAZA
- 02. UNDERGROUND LEVEL 1 - TAIPEI NEW WORLD SHOPPING CENTER
- 03. UNDERGROUND LEVEL 2 - TAIPEI NEW WORLD PARKING AREA



Taipei Main Station

Taipei New World Shopping Center Plaza

Shin Kong Mitsukoshi Department Store

National Museum of History

228 Memorial Park





THE MORPHING PATTERN IN THE SKY

In Taiwan, wires fixed with poles on the streets overspread the public space. When passing this kind of space, people can see a kind of morphing pattern in the sky.



VIEW TOWARD SKY FROM K9 ENTRANCE



SERIES OF SECTIONAL MODEL



1.6M

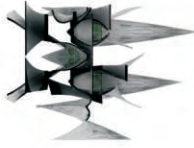

3.6M



5.6M



7.6M

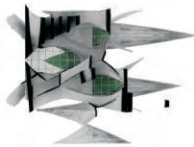

9.6M



11.6M



13.6M



15.6M



17.6M



VIEW TOWARDS TAIPEI MAIN STATION FROM SOUTHERN STREET



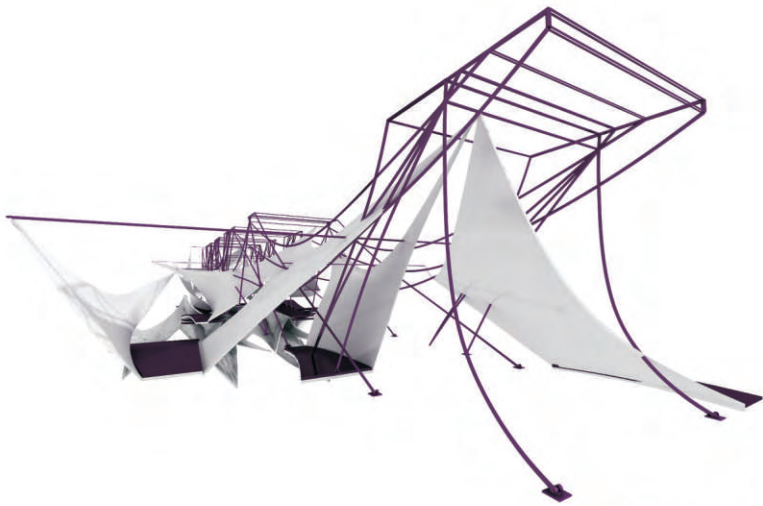

SOUTHEASTERN VIEW

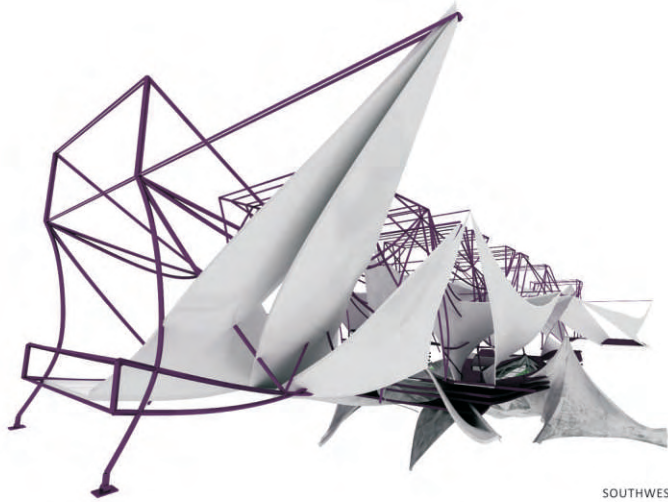

SOUTHWESTERN VIEW

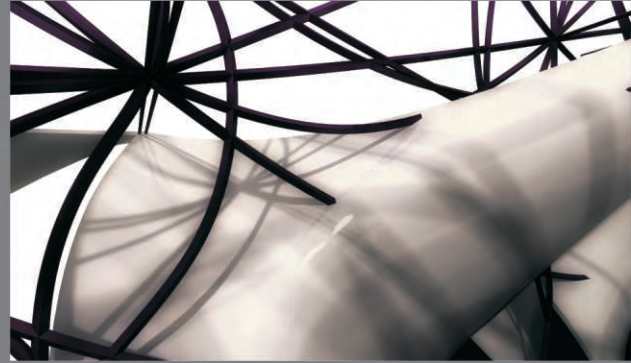

Dramatic pattern on FRP structure
As a sunny day, stainless steels' shadows and reflections project on the surface of FRP structure



DETAIL

- 01. - STAINLESS STEEL "FEET"
- 02. - STAINLESS STEEL "WEBS"
- 03. - BOLT FIXINGS
- 04. - STEEL PLATE
- 05. - CONCRETE PILE CAPS

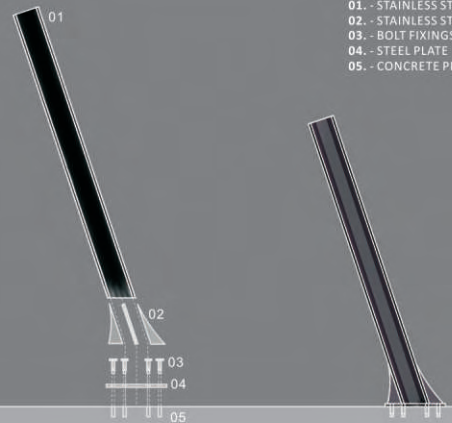



- 01 K12 ENTRANCE
- 02 THE PLATFORM
- 03 THE RAMP TO UPPER LEVEL
- 04 THE CORRIDORS BY THE SIDE OF THE SKYLIGHT WELLS
- 05 THE SKYLIGHT WELL
- 06 UNDERGROUND LEVEL 1 - SHOPPING CENTER
- 07 UNDERGROUND LEVEL 2 - PARKING AREA
- 08 STEEL STRUCTURE FOR FRP
- 09 FRP STRUCTURE





ORIGINAL SKYLIGHT WELL INTERIOR



ORIGINAL SKYLIGHT WELL EXTERIOR

THE "EYES" ON THE GROUND

To improve the connection between ground level and underground level, the skylight well - "Eyes" have many stop-off area and three wells covered with the crystal glass. People standing on underground level can obtain the skylight through the wells.



THE SKYLIGHT WELL - "EYES"





01 PLATFORM

➤A cantilevered platform with the steel ground and smooth wall. As standing on the platform, people can enjoy the whole view of the plaza.

02 SKYLIGHT WELL

➤The skylight well which is called "Eyes" is formed with concrete to construct a shell structure.

03 RAMP

➤The gradual ramp is sustained by the steels. People ascend the narrow ramp to the cantilevered platform.

04 CORRIDOR

➤The small gibbous corridors are constructed by the steel plates.



CANTILEVERED PLATFORM

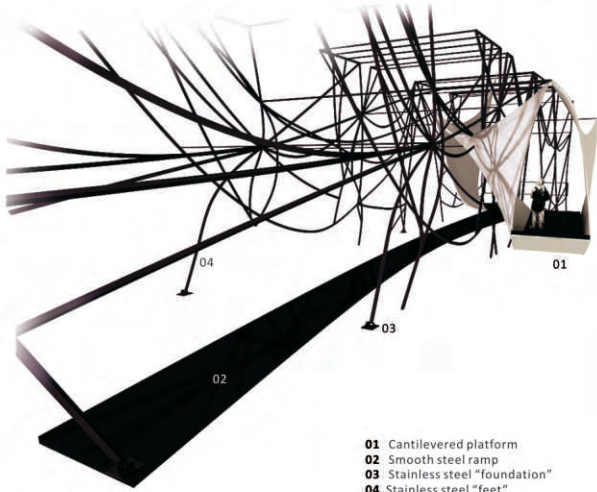

- 01 Cantilevered platform
- 02 Smooth steel ramp
- 03 Stainless steel "foundation"
- 04 Stainless steel "feet"

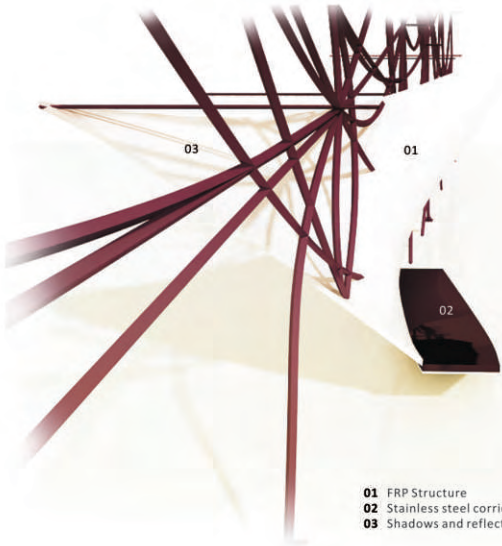

- 01 FRP Structure
- 02 Stainless steel corridor
- 03 Shadows and reflections on FRP structure





SKYLIGHT WELL INTERIOR VIEW FROM K12 ENTRANCE



SKYLIGHT WELL INTERIOR: LIGHT THROUGH GLASS ON A SUNNY DAY



- 01 Smooth concrete free form
- 02 Skylight well - "Eyes"
- 03 Piping shaft



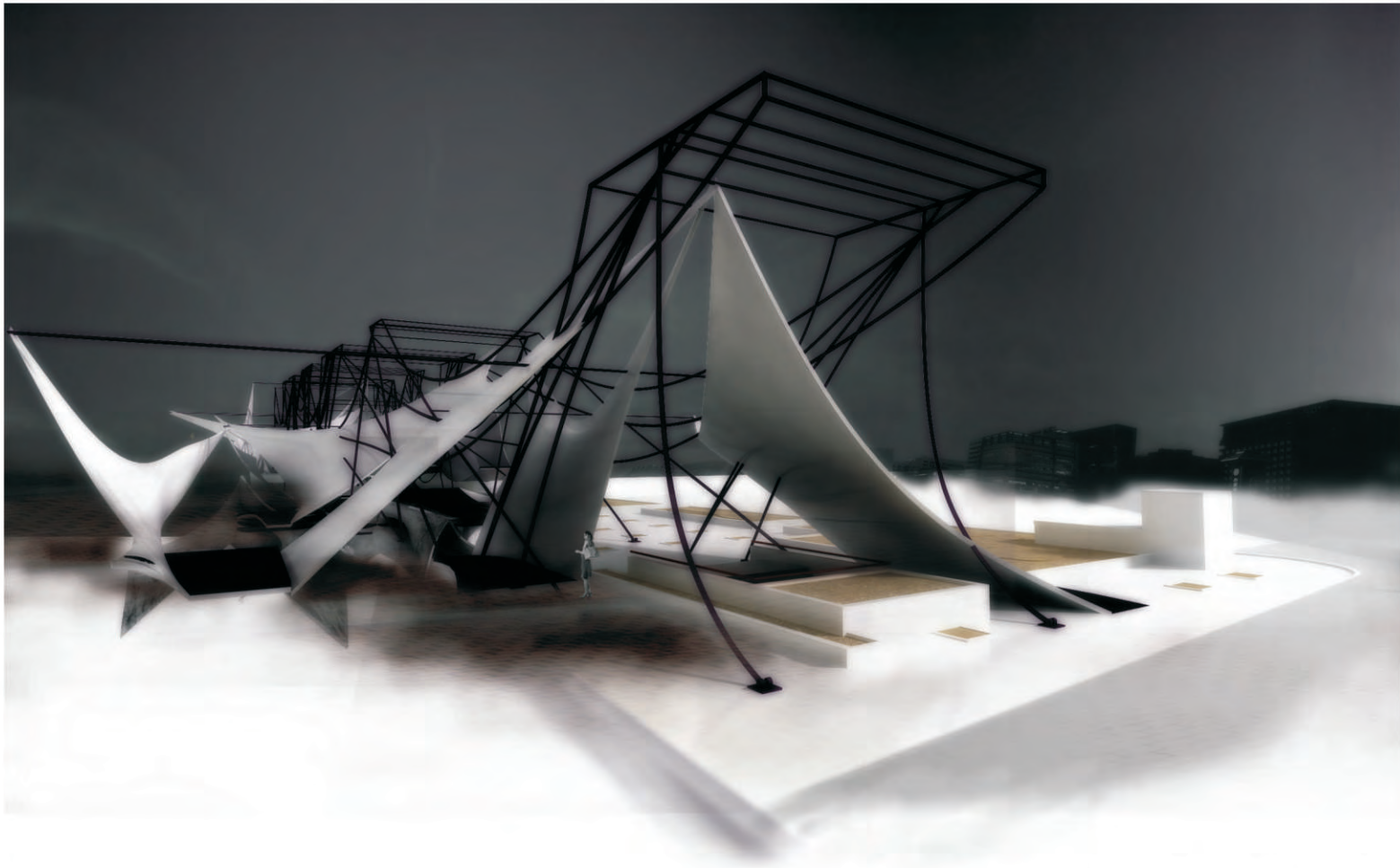

VIEW TOWARDS TAIPEI NEW WORLD PLAZA FROM ZHONG-XIAO WESTERN ROAD

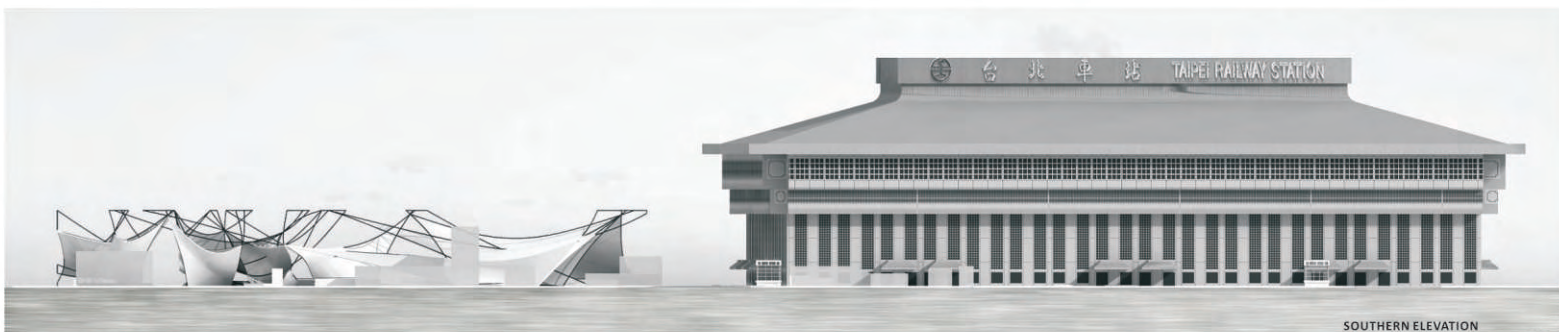

SOUTHERN ELEVATION



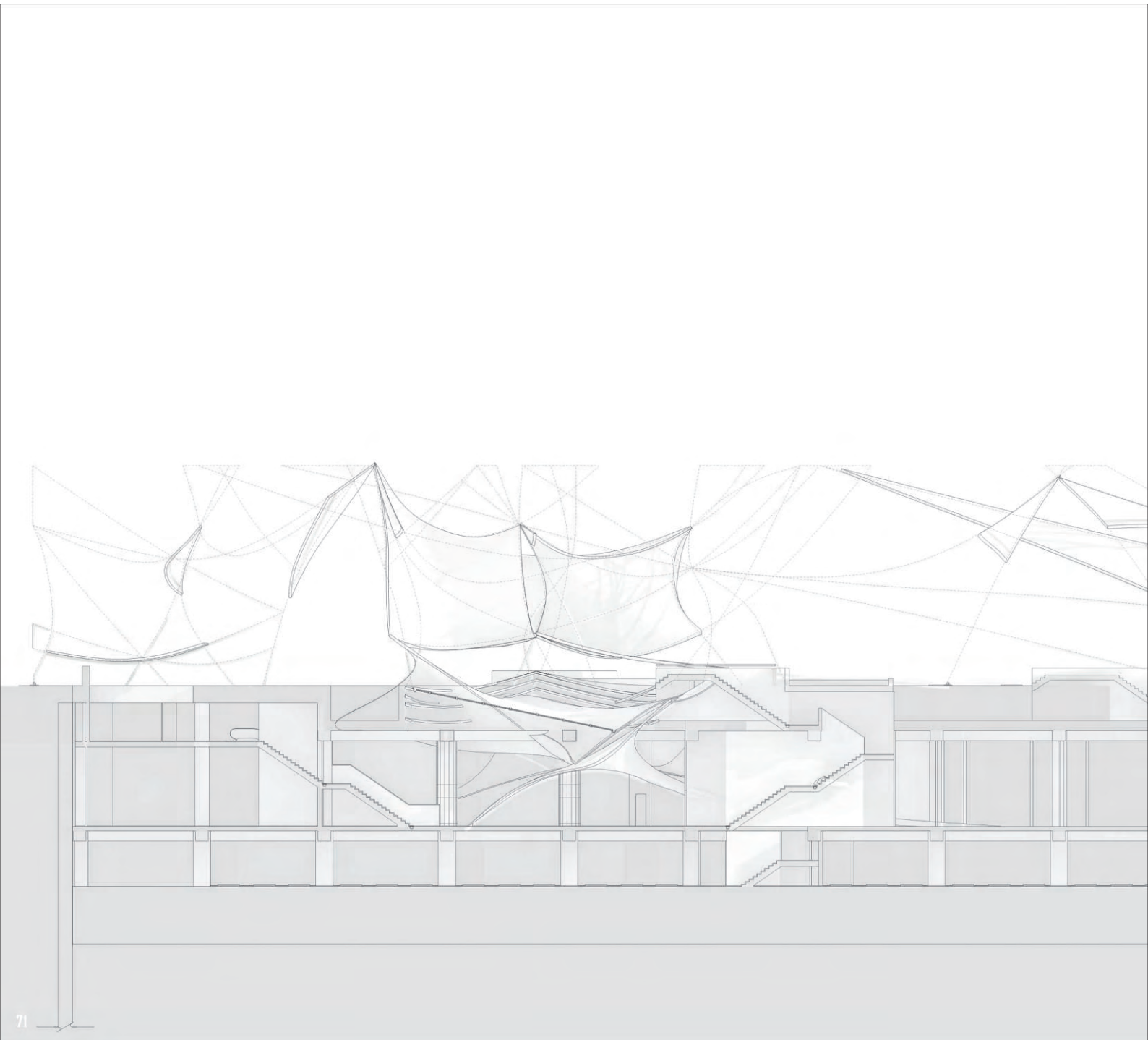

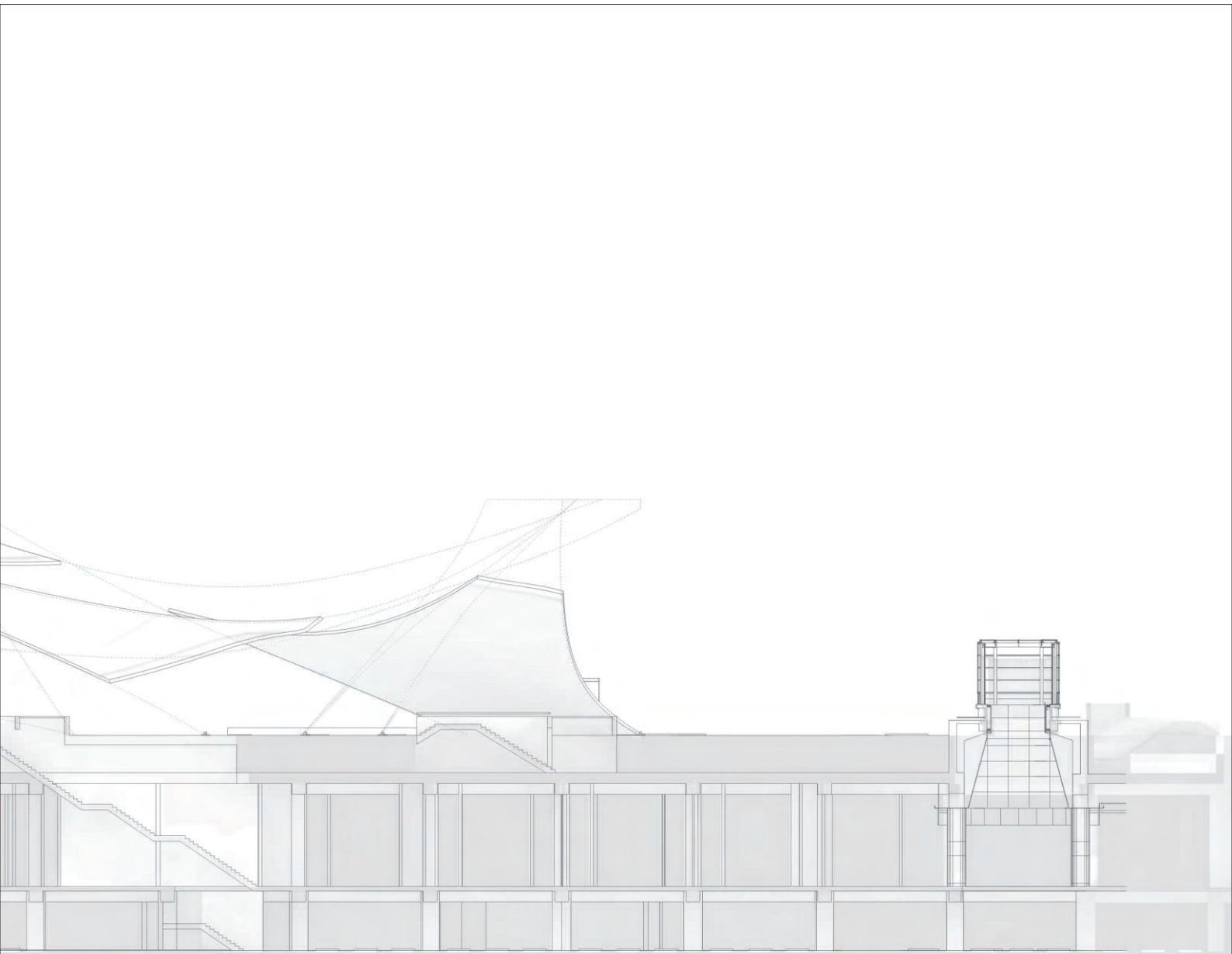

SECTION



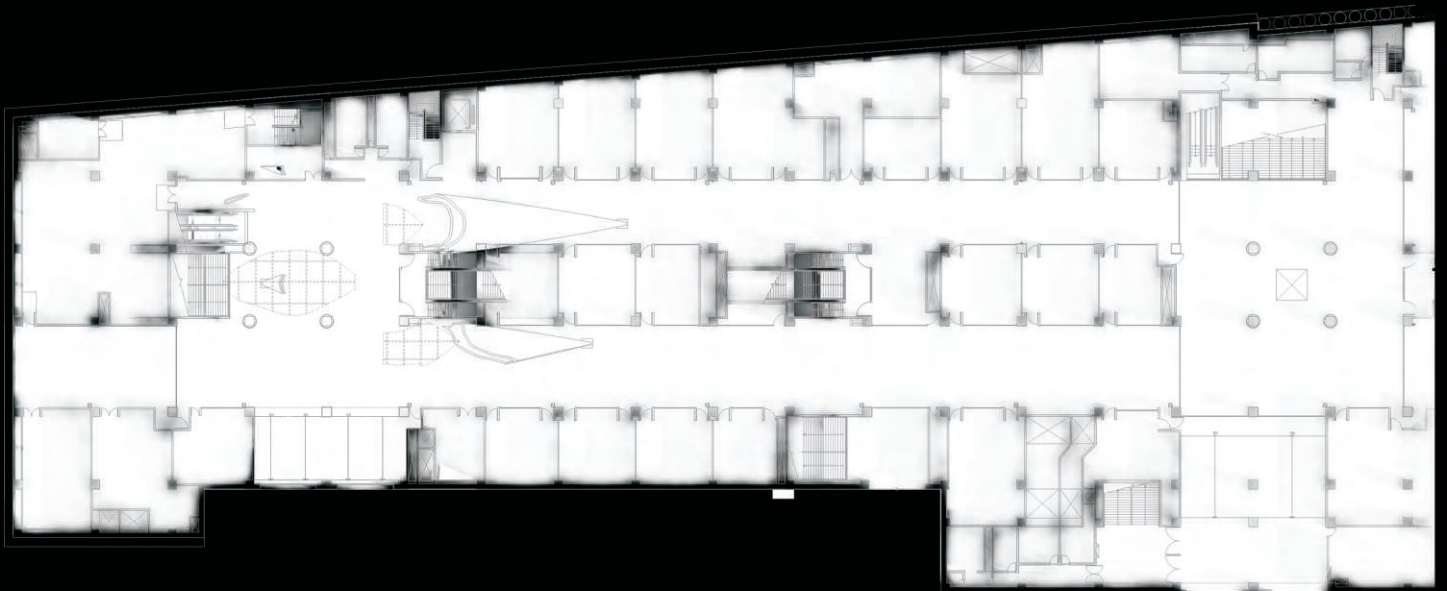

UNDERGROUND LEVEL 1 



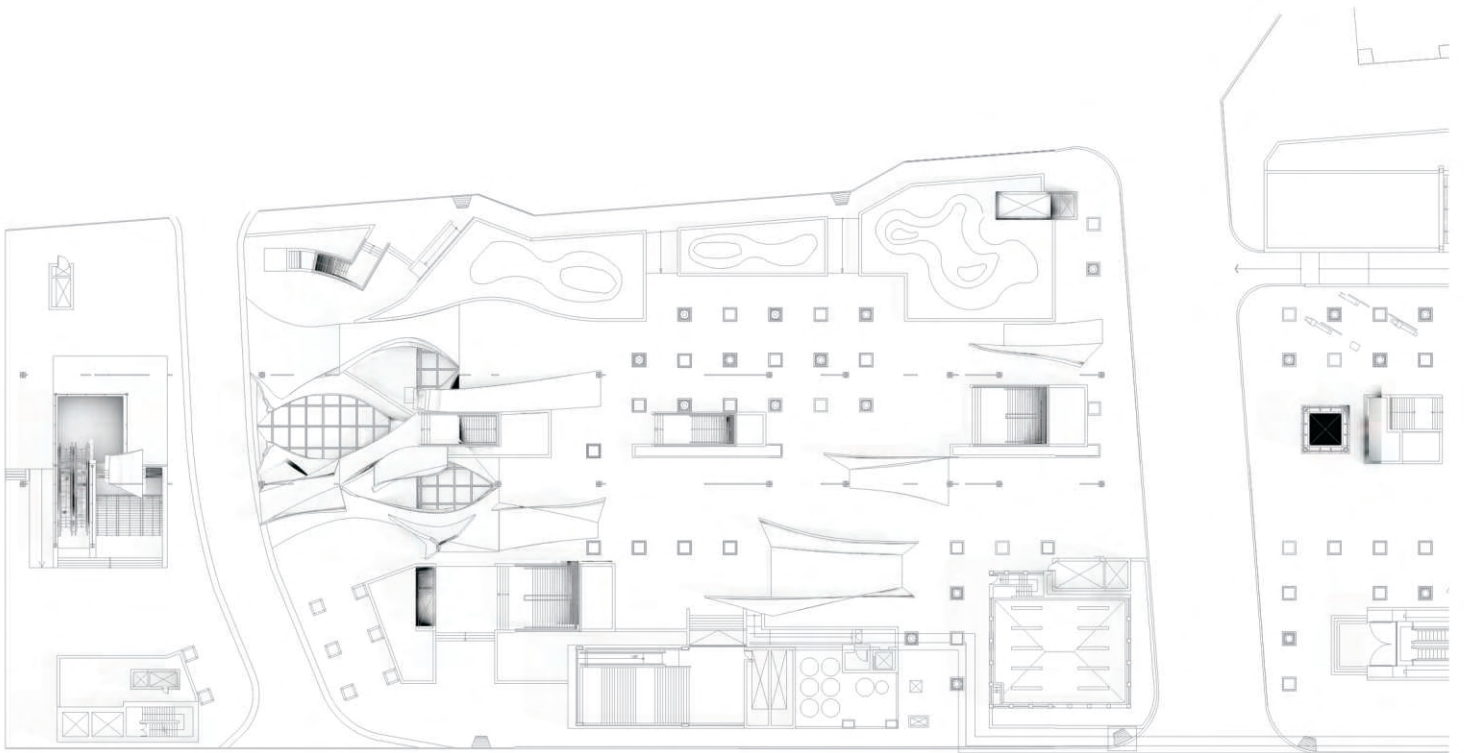

GROUND LEVEL 1 



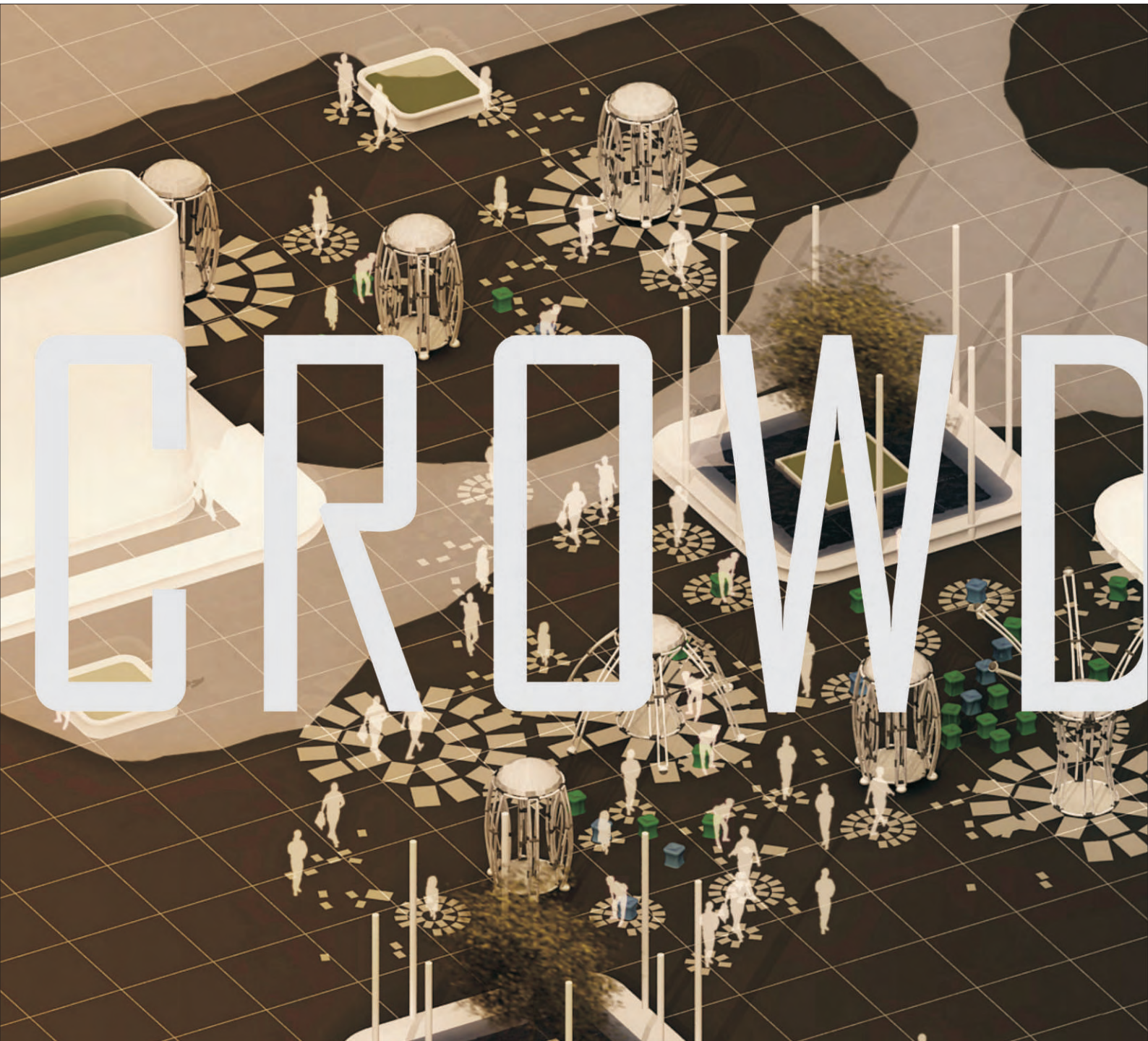



ESCAPE



Douban (Hi)story Library

Location: Taichung
Advisor: Shu-Chang, Kung & Jr-Gang, Chi
2007 Fall



CROWDSCAPE

Crowdscape專注於數位時代下網路社群研究，研究此類新興的社會結構，從中建構其特殊空間概念之景，而再藉以此概念實踐於一種屬於當代社群的實體圖書館。Douban (hi)story Library即為這個論述的實踐設計案。

Douban (hi)story Library, a physical Library which reacts on virtual community website such as Douban provides a virtual and reality interactive space for Douban communities.

This project aims at rebuilding a new relationship of dynamic grouping system in contemporary library's theory.

RESEARCH

數位網路時代WEB2.0的來臨，大量興起如豆瓣網(Douban)此類的虛擬社群網站，社群透過網路進行各種關於圖書、電影、音樂的互動與交流，本案以豆瓣網為例，透過研究此類社群網站的連結架構及社群溝通互動的方式與內容，理解當代數位知識與書本與社群中，人與人與知識的關係在這樣的虛擬網絡中呈現多向性連結，知識內容則透過超文本的相互參照指涉的關聯性。

CONCEPTUAL SCOPE

從研究中的理解與詮釋，建立具概念式的互動空間Knowledge Space，它被視為階段性的scape，重新詮釋人與人、人與知識、知識與知識之間的關係，在空間中以數以萬計的影像占據領域的方式，反應數位資訊時代中動態的群聚與分散關係。

SITE

基地設定於台中國家圖書館的預定地，作為豆瓣社群圖書館的興建地點，基地西面面臨台中地方法院，東面則面臨綠園道，作為一個都市的開放空間連接點，對待基地的策略為將整個圖書館下降半層樓高，作為連接都市活動的廣大的半地下開放空間。

PROGRAM

不同於過去傳統的公共圖書館，豆瓣圖書館是為豆瓣社群而設立的社群圖書館，而相較於過去圖書館主要為典藏書籍而設立，豆瓣圖書館提供更多的公共活動空間，讓社群在這類廣場的平台上產生不同的知識交流。

STUDIO INTRODUCTION

The project aims to host research-assisted investigations of the library in the digital age of information.

We focus our study on a broadened sense of the books and activities in the library based on the critical discussion about the Cultural, Social, Ritual, and Symbolic System. further, this studio explores a new spatial conception - i.e. "transformative and interactive space" based on the concept of "change." The investigation centers around three types of change: formal, spatial, and relational, that manifest architecturally as a morphing enclosure(the skin) with adaptation programs(the organs) and their variable in-betweens(the space in-between). Then comes a question: how does one comprehend such a spatial system where a constant is relatively missing, and hence impossible to establish a reference point? The concept of "Anatomical position" was introduced as a basis for developing descriptive models to conceptualize the dynamic space in question. Moreover, the discussion was extended from the physical to the cyber space and their interfaces.



RESEARCH STORY

超人四三六放下手邊羅蘭巴特的「明室」，在筆記本裡寫下最後一段閱讀心得摘要後，打開桌上的電腦，沖了杯熱咖啡，像是每日例行公式般的連上了豆瓣網，看看有沒有新的友鄰加入他為好友，發現一位自稱「亞米」的豆友設他為友鄰，超人四三六驚奇地擊點了亞米的閱讀清單，發現亞米在兩個小時前剛發表了關於「明室」的最新評論，他發覺亞米所下的評論和自己的心得摘要有幾分相似，於是決定發封電郵給他，希望約他到「羅蘭巴特」的小組一起來交換閱讀「明室」後的心得。超人四三六和亞米是豆瓣網社群的一份子，他們透過豆瓣網來互相交換關於圖書、電影、音樂的資訊還有心得，甚至可以加入小組，討論不屬於這些知識範圍的其他事物。事實上，豆瓣網幾乎所有的功能都可以用搜索、儲存、分類和分享這幾個詞來概括。豆瓣網創辦人楊勃從2005創豆瓣網以來，經過兩年多的成長，超過33萬的註冊用戶在豆瓣上有了自己的空間和自己的圈子，創辦人楊勃提到「像這樣因為web 2.0的興起而新興網路虛擬社群，豆瓣網只是其中一個例子。」

THEME

野餐(Picnic)，在這個設計案中，被用以描述現代人在數位化知識與傳統知識並存影響下，以一種不固定的、游離的、變動的、隨機的，甚至輕鬆的方式，對它們有新的獲取與互動，亦同時思考這樣方式所形成的特殊群組關係，能否成爲一種全新的都市地景，展現當代人與知識、人與人之間的動態群組關係。



豆瓣網的虛擬使用者透過書本、電影、音樂等知識產生不同的群組關係，會員們亦透過這些知識產生不同的互動。

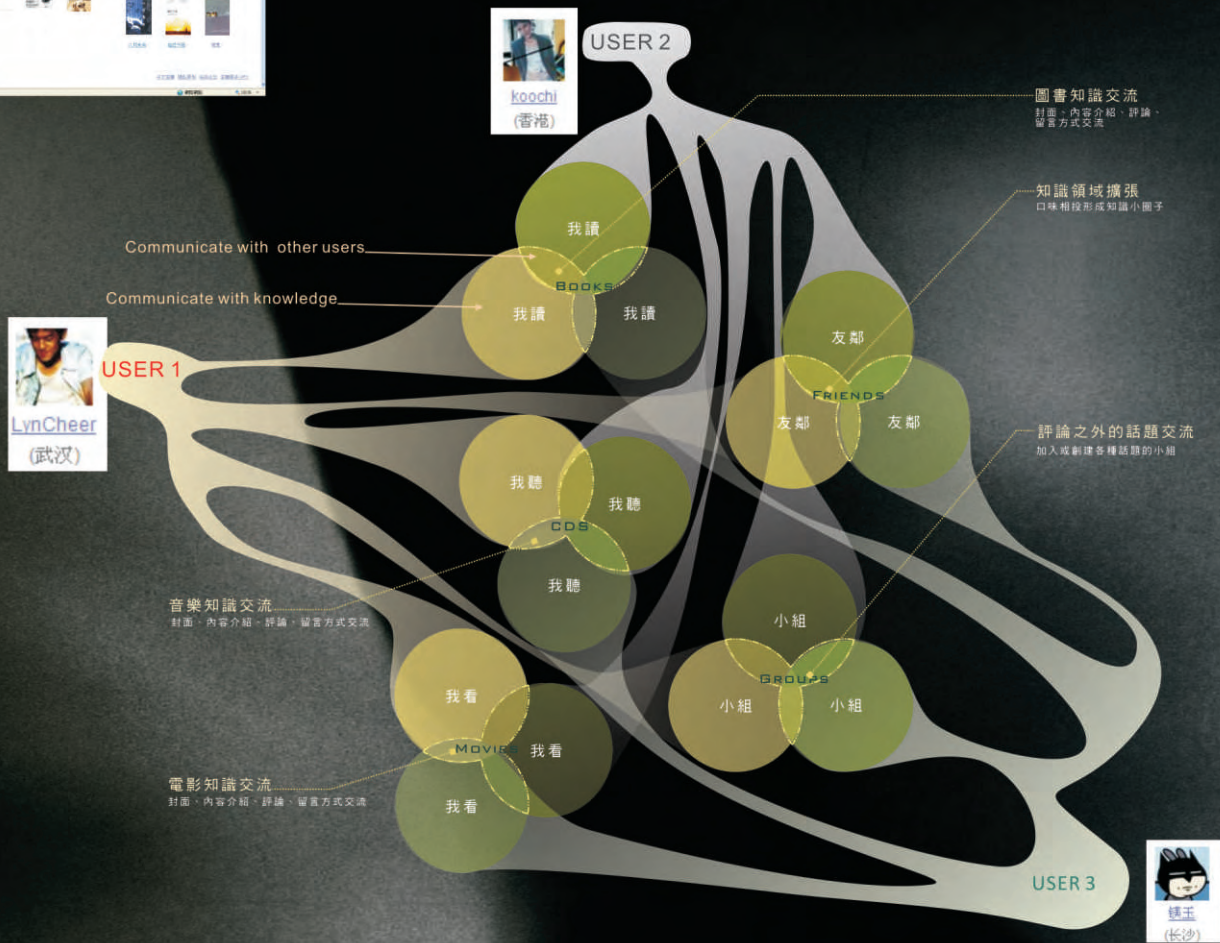

DIGITAL INTERACTION

豆瓣網的使用者與知識的關係，被反應成一種數位顯影的互動系統，使用者進入這樣的數位互動空間中，能夠及時連結豆瓣網的資訊，成為個人的知識領域，界定使用者的空間領域。

RELATIONSHIPS IN KNOWLEDGE SPACE

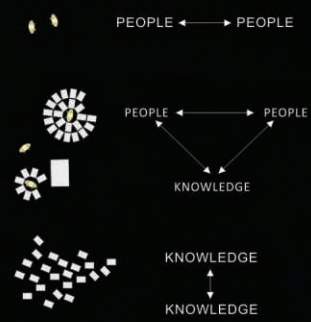

ELEMENTS IN KNOWLEDGE SPACE

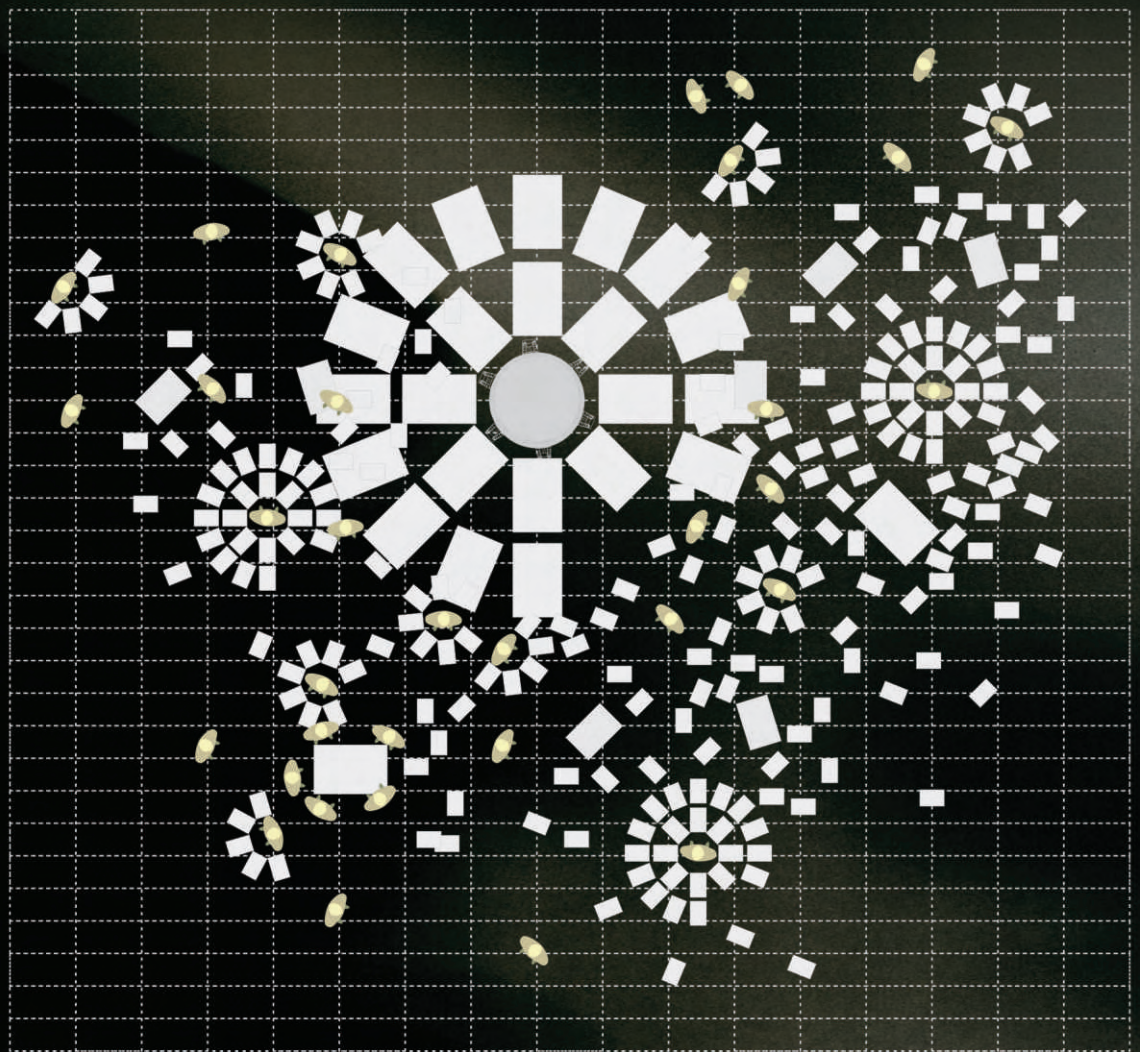

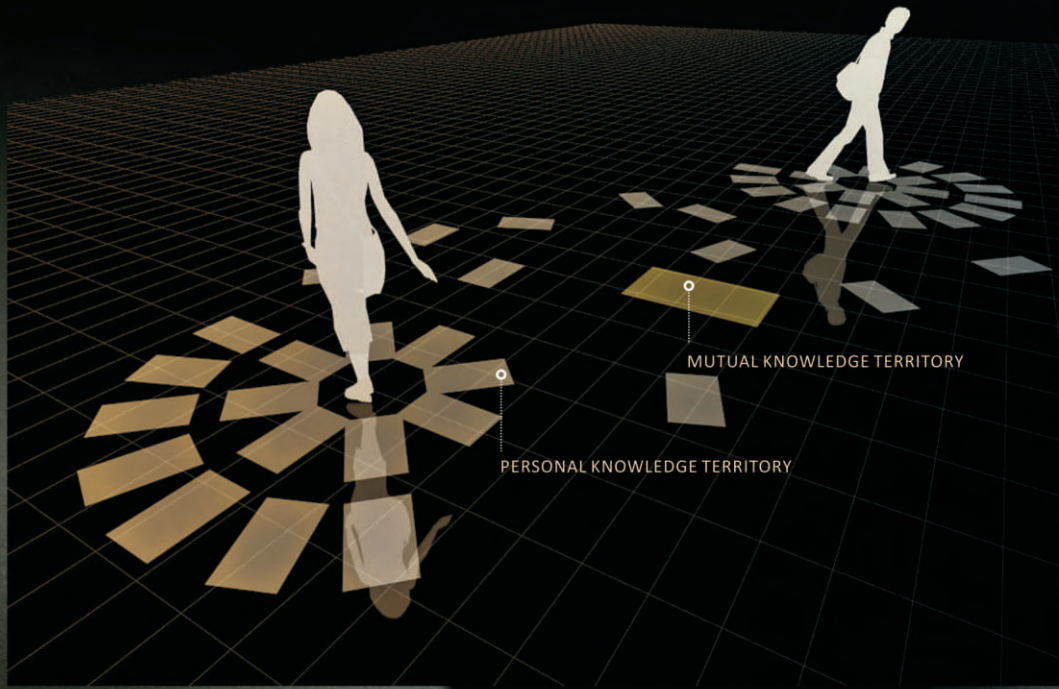

MEMBERSHIP

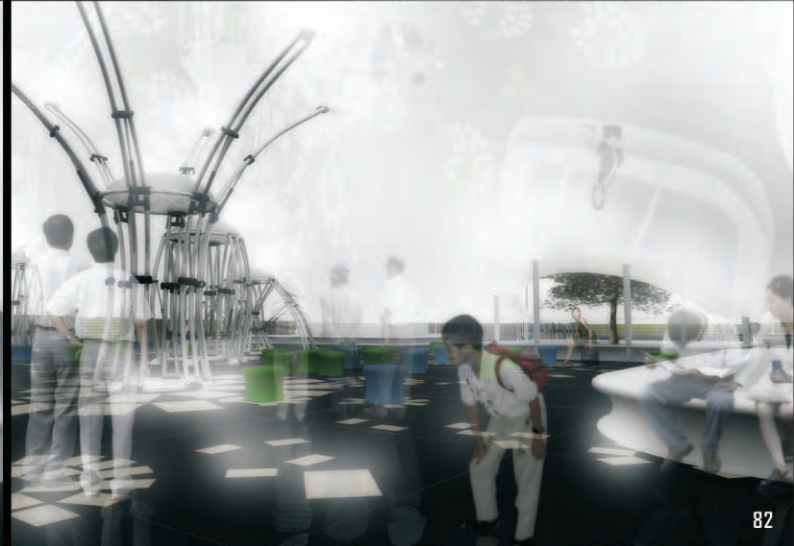
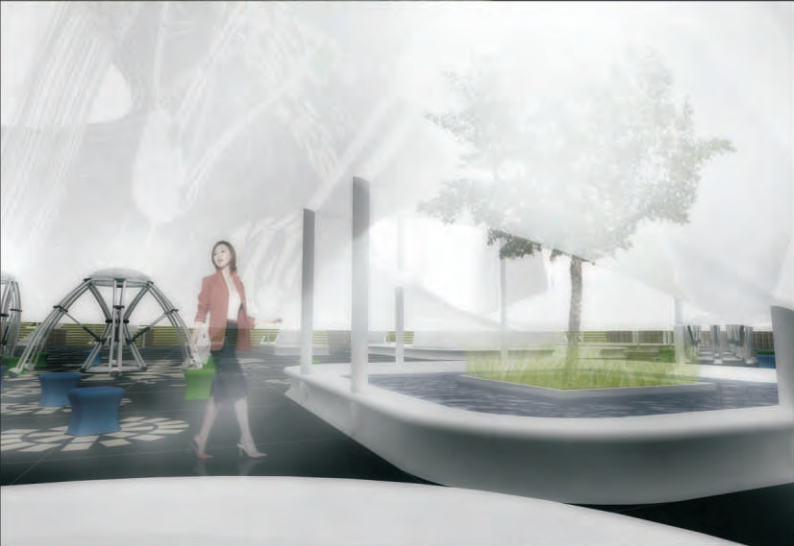
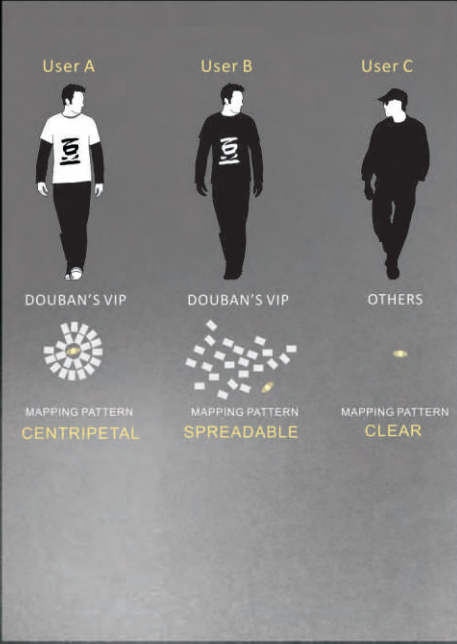

VIRTUAL BOOK'S IDENTITY

豆瓣網的使用者對於書本、電影、音樂等知識給予評論與閱讀心得，而賦予那些知識新的識別性以及獨特性，使它們脫離原本中性的知識，成為屬於豆瓣社群的知識內容。這些知識，以書本為例，將被分成四種類型，定義它們的方式，是透過豆友們在一定時間內的評論數量統計成曲線圖而區分。曲線本身除了反應豆瓣社群的知識活動內涵外，也同時反映知識本身的價值性。換句話說，書本、電影、音樂等內容的價值性，將透過豆瓣網這類的知識社群重新給予定義。



TYPE A
達文西密碼

評論統計

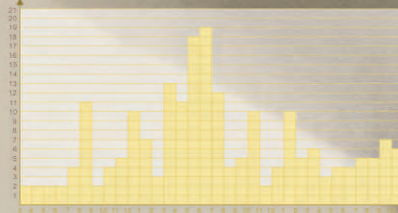

時效性曲線



TYPE B
第一次親密接觸



TYPE C
挪威的森林

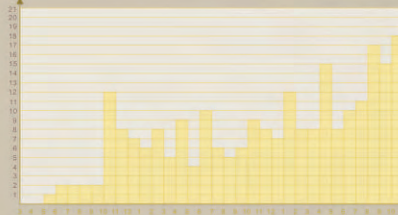

TYPE D
瘟疫

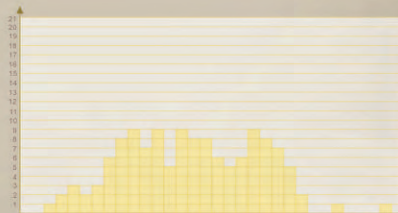



TYPE 1

UNMOVABLE

評論曲線水平成長



Type 2

MOVABLE

評論曲線持續上升



Type 3

UNMOVABLE

評論曲線趨近為零



TYPE 1

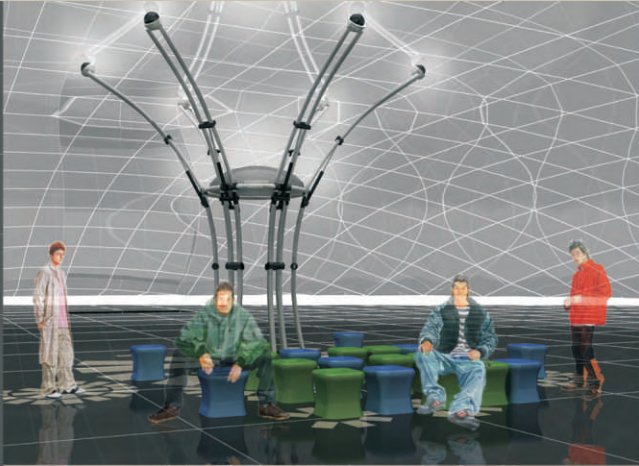
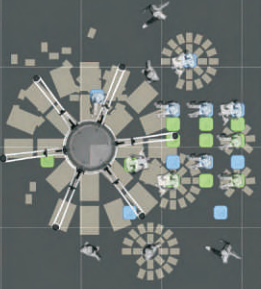

TYPE 2

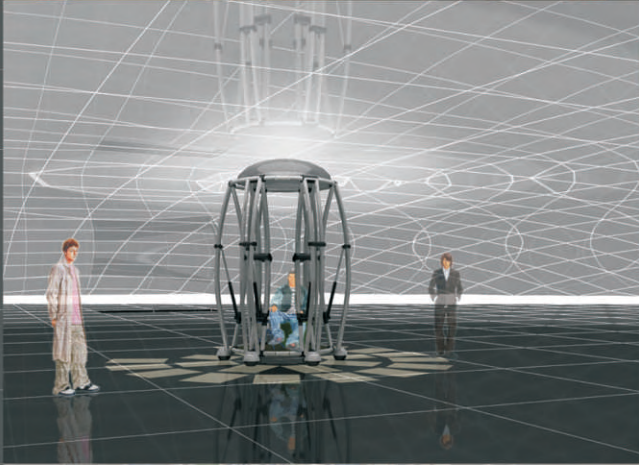

TYPE 3

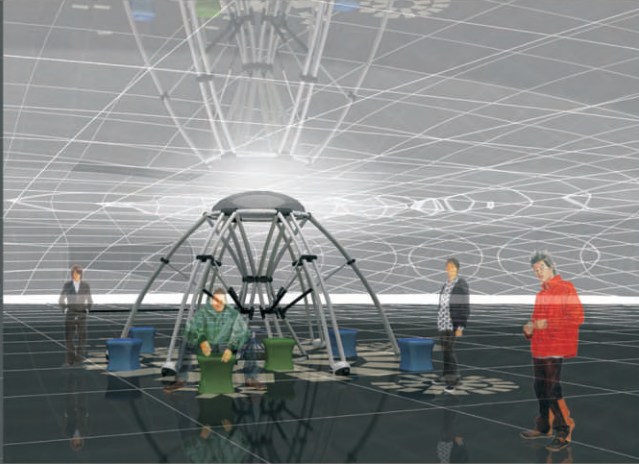

PROGRAM

KNOWLEDGE CANON有兩個主要的機能設定，其一是作為可移動的結構物頂上的拉張膜結構，透過不同的結構形態作知識的不同展示方式，另一個設定為個人閱讀空間以及社群聚集的場域界定，滿足互友們各種討論、演講、小組聚會等不同使用。

PHASE 1



PHASE 2



PHASE 3



PHASE 4



PHASE 5



ALTERANT SPACE

在巨大的拉張膜上開了數個採天光以及洩水的天井，隨著移動結構的支撐與否，改變空間的領域範圍，同時將室外的光、水與植物反轉進入室內。

PHASE 1

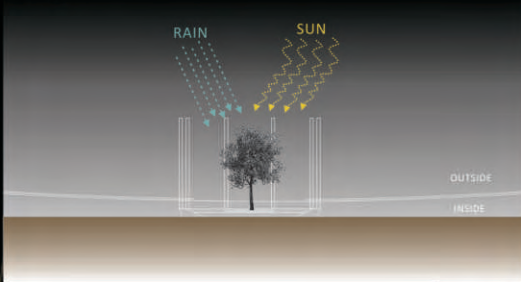

PHASE 2

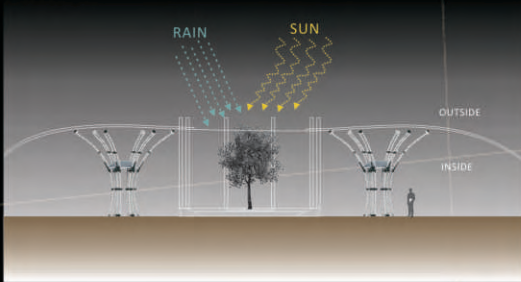

KNOWLEDGE CANON CONTENT

KNOWLEDGE CANON分成以下幾種元素，豆友進入後，能夠閱讀實體書，並同時得到豆瓣網此本書的數位內容，地板同時顯現在豆瓣網的個人閱讀資訊，占據空間領域。

- 01 DIGERATI PROJECTION
- 02 AUTOMATIC CHAIR
- 03 A REAL BOOK
- 04 PERSONAL KNOWLEDGE TERRITORY



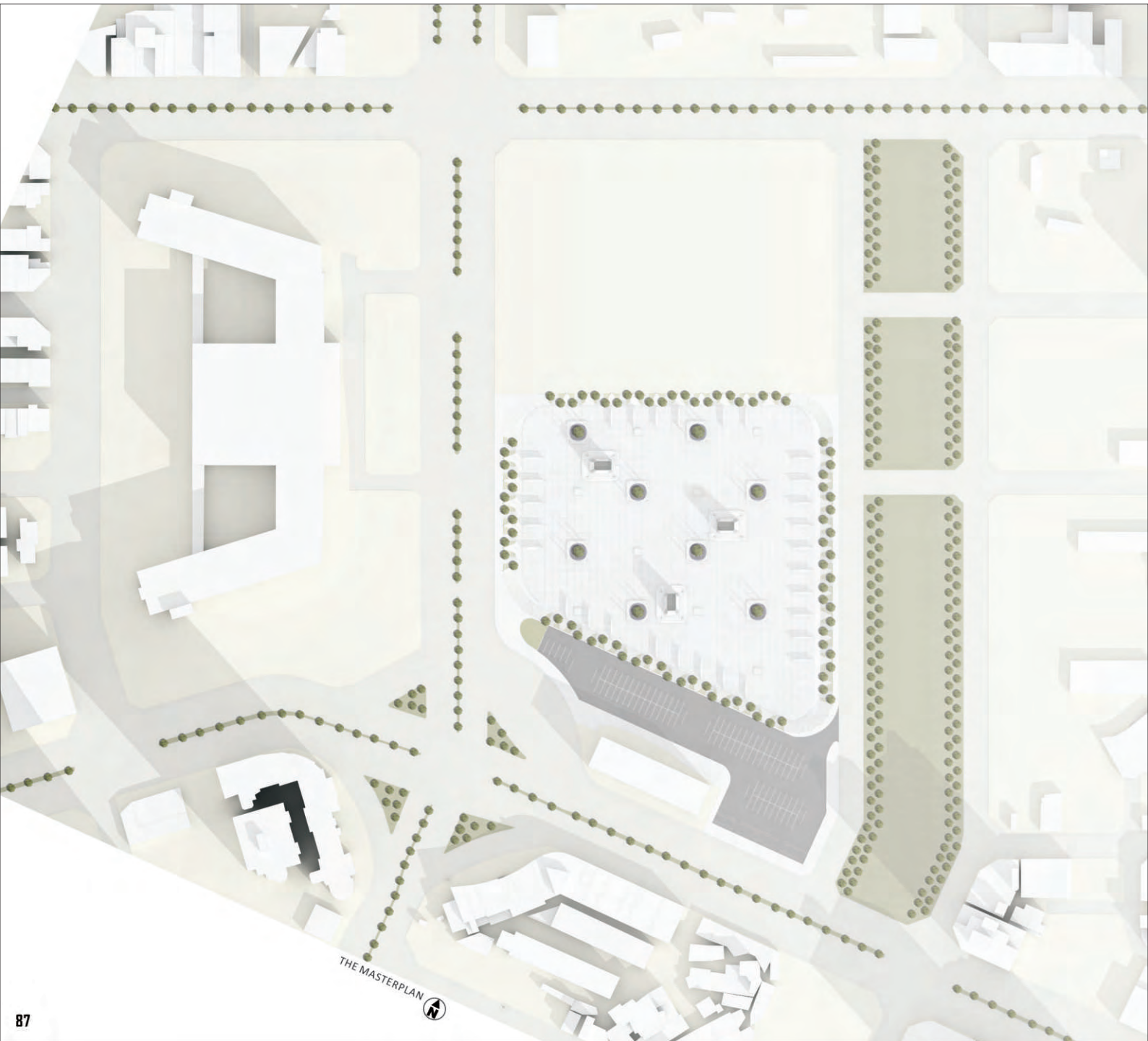

THE MASTERPLAN 



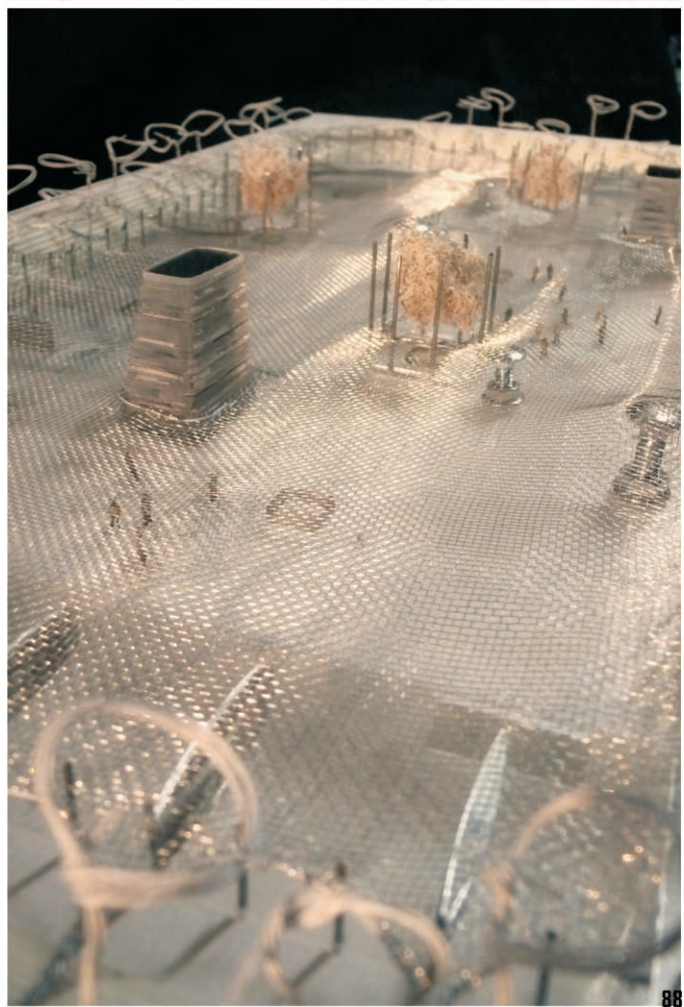
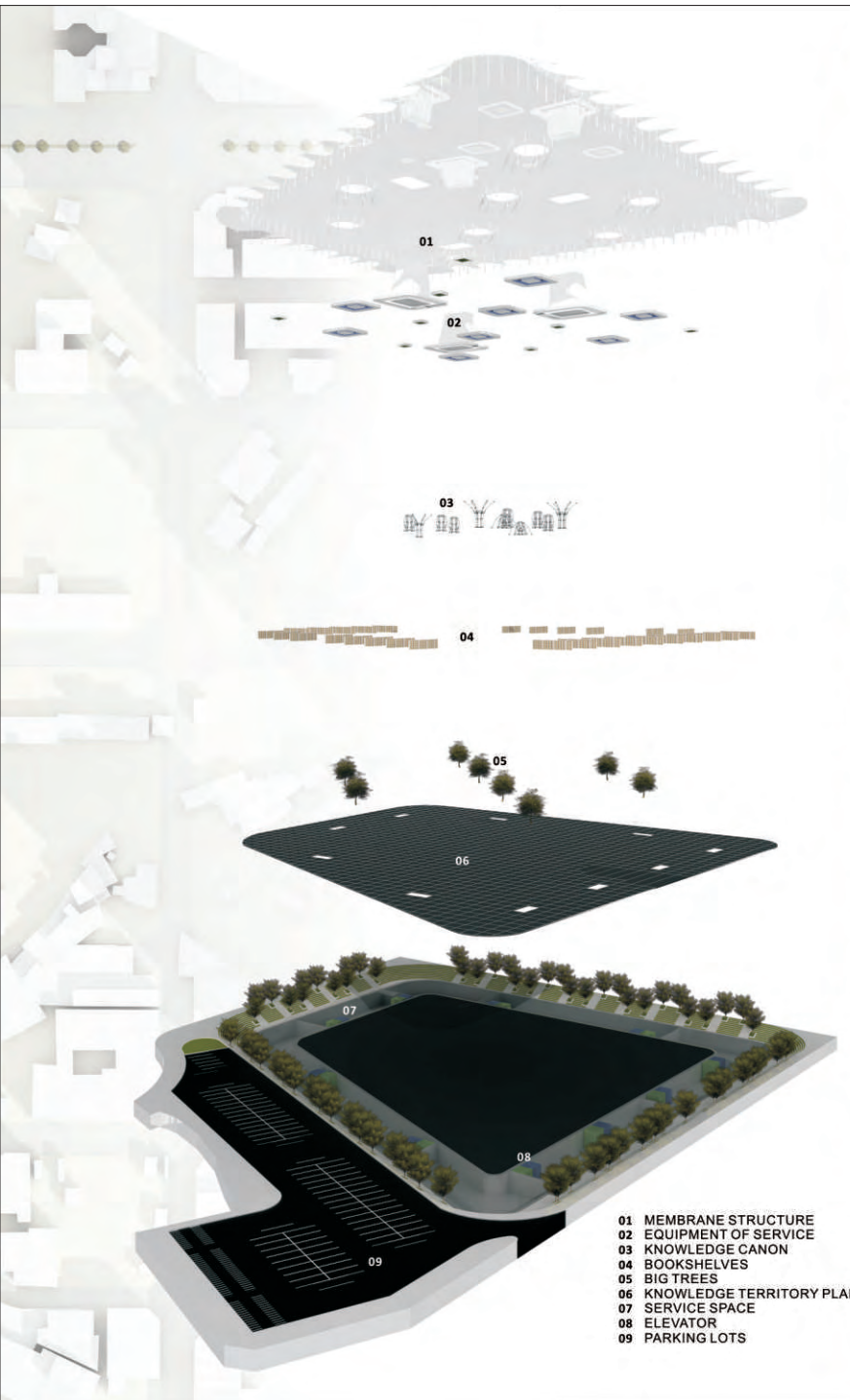

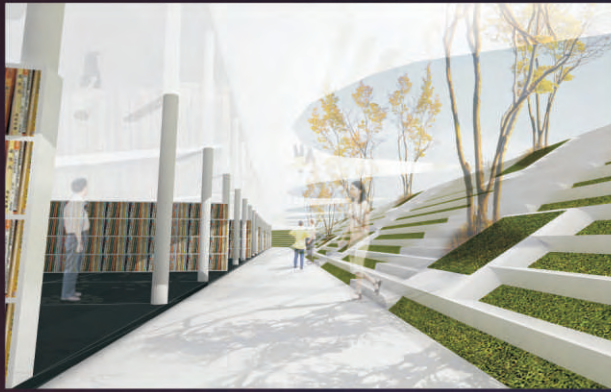

DOUBAN (HI)STORY LIBRARY

在夜裡，巨大的拉膜結構隨著圖書館中人群活動不斷地變動著，伴隨活動而發出的人工照明以及變動的地景為都市提供另一種閱讀景致。我們的豆史圖書館，一個反映當代虛擬知識社群與實體空間中人與人、人與知識互動的新動態關係的圖書館。

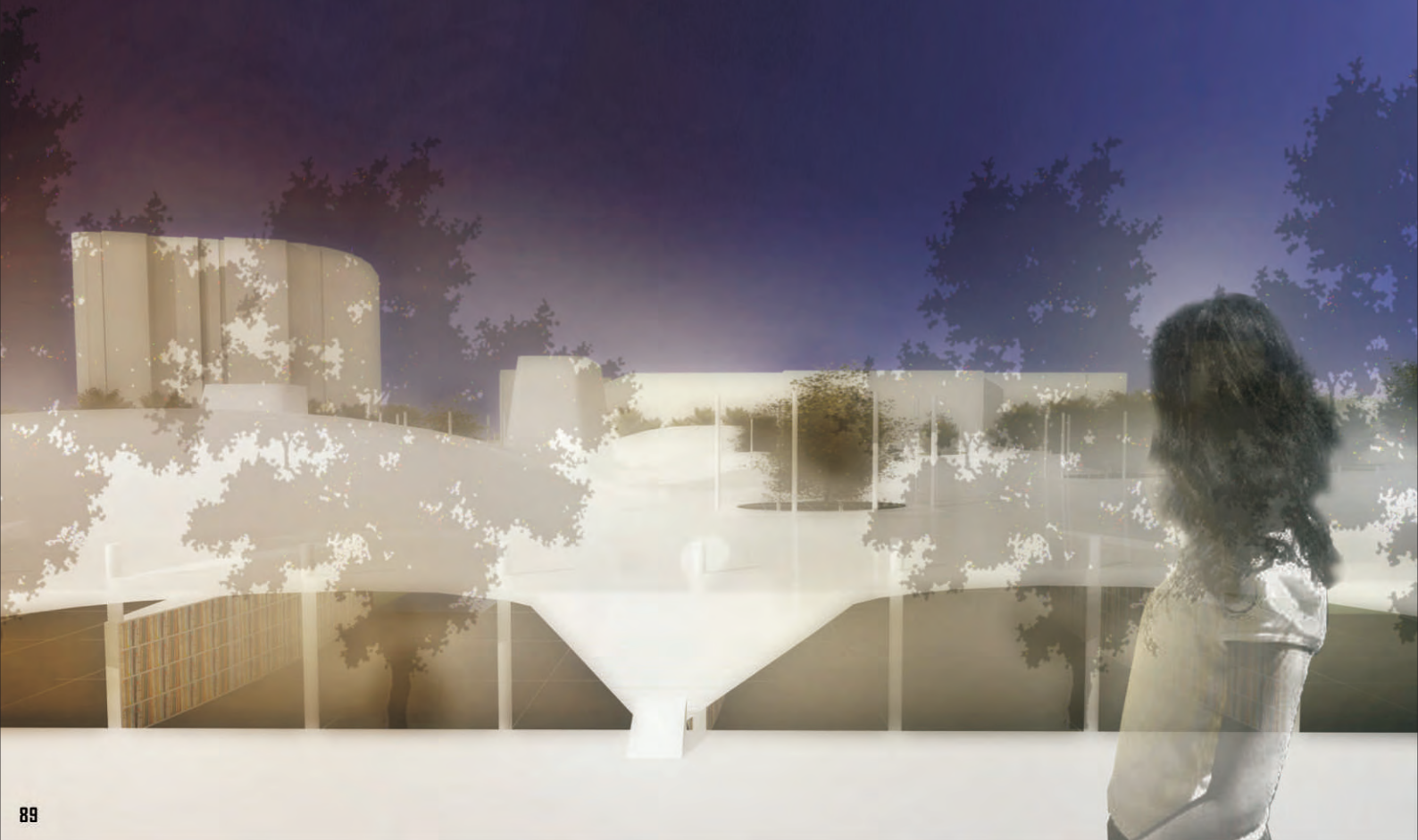

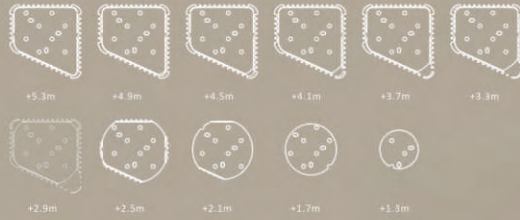
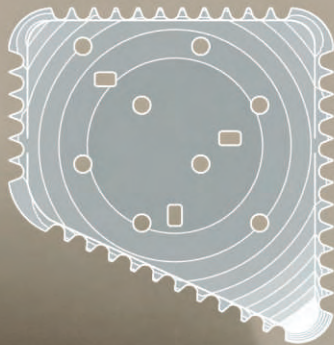

EVENTS: CLOSED
MEMBERSHIP: 0 人次

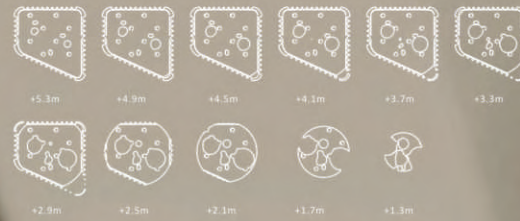
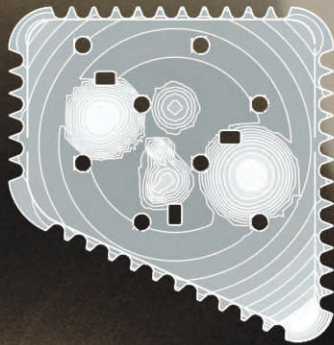

EVENTS: USUAL DAYS
MEMBERSHIP: 50 人次



EVENTS: DOUBAN ANNUAL CONFERENCE
MEMBERSHIP: 500 人次

CROWDSCAPE

我們的豆史圖書館，對於豆瓣社群提供一個人與人、人與知識、人與空間、知識與空間的全新互動關係，圖書館回應都市面向，透過一個隨著動態群組改變的雙層拉張膜結構，與周遭環境產生互動，這個隨著人的群聚與分散而改變形態的結構模，反映當代社群的一種溝通互動消長與聚集分散的新形態，成爲一種以群眾爲主體的群眾地景（Crowdscape）。

以拉張膜的三種變形形態爲例：圖書館閉館時、平時開館時以及豆友年度聚會時，拉張膜所被支撐起的高度因爲社群人數的多寡，而有極大



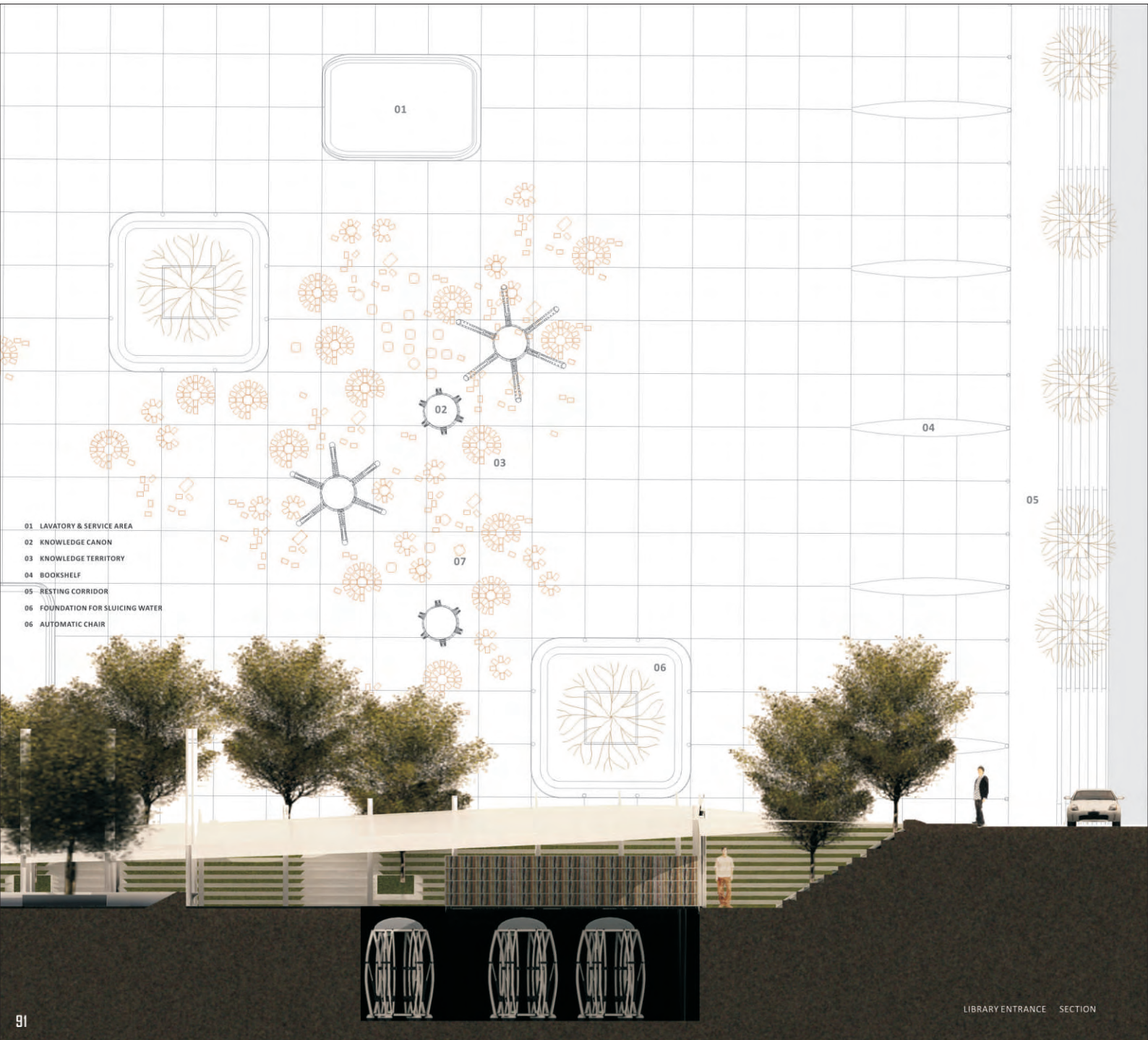

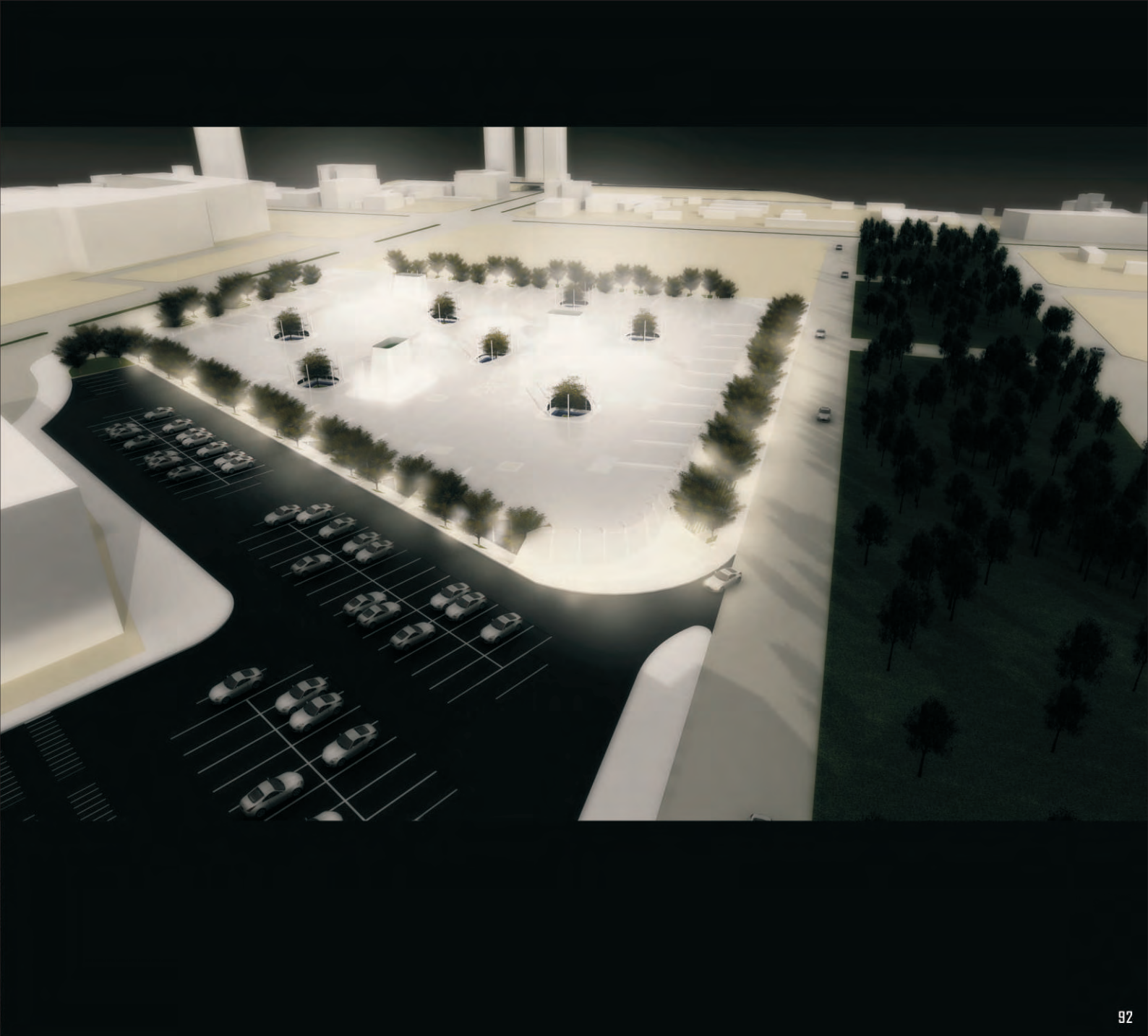



INTRODUCTION

In this workshop, the students are asked to think about some of the problems we have in Rotterdam with the waterfront city concept. Therefore I would like to challenge the students to think about solutions for a particular stretch of the city in Rotterdam called the Schiedamsedijk. It is in fact the extension of the Coolsingel, reaching from the Maritime Museum to the landing of the Erasmus Bridge. This is at the moment a difficult and weak link in the connection from the city center to the river. I would like to ask the students to think about this stretch of city, and to see if they can come up with design solutions to increase the quality of the connection. This project combines urbanism, thinking about public space and even landscape and water, with architectural potential.

The workshop will start with an introduction about this piece of city, its character, history, policies and public space qualities. As the role of public space and continuity of the city-scape is of increasing importance in the field of architecture and urbanism today, and is one of the large subjects in the international architecture debate currently, the introduction will also touch on some trends and developments going on in the Netherlands and in the world.

ISSUE

Rotterdam has traditionally developed as a port city. Since the 1970's, most of the bulk ports have moved out of the city and transformed into larger scale new ports, closer to the sea. About 15 years ago, Rotterdam has started to redevelop into a waterfront city, where the center and the water should be much more connected. For this purpose, a new bridge was built (the Erasmus Bridge) and large scale developments were started up on the south bank of the Maas river (The 'Kop van Zuid'). As the waterfront projects are in progress, it is becoming evident that the connection between the old center of Rotterdam and the river remains weak. Between the central boulevard, the Coolsingel and the Erasmusbridge, there runs a stretch of road called the Schiedamsedijk which is not living up to its potential as a main connector between city and river.

THE BIG ZIPPER

Student: Po-Yu, Chao
Liu-Yin, Lin
Hsin-Her, Lin
Chia-Wen, Tsai
Chia-Ching, Lien

Location: Schiedamsedijk, Rotterdam

Advisor: Jaakko van 't Spijker

2007, October 26 – October 30





TULIP FARM

CONCEPT

我們以鹿特丹近郊區由鬱金香田所有形
成的農業水景作爲概念，亦應對找到一個具備傳統的立向道性。這出結性。租農地，配而爲南都，爲香金系，而

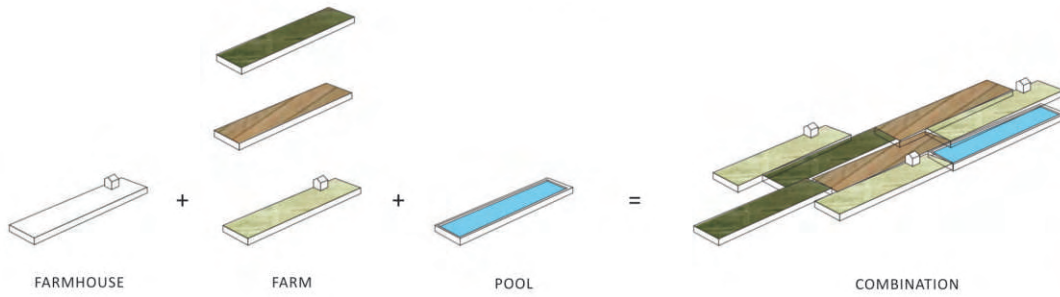

IRRIGATION SYSTEM

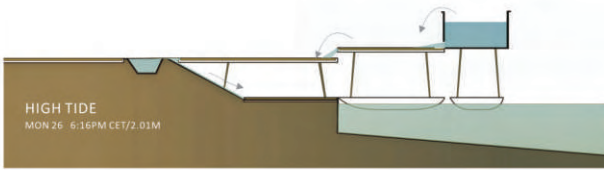

HIGH TIDE
MON 26 6:16PM CET/2.01M

RESEARCH - TIME & TIDE

NOVEMBER 2007 ROOTTERDAM

| | HIGH | LOW | HIGH | LOW | HIGH |
|--------|-------------------|--------------------|------------------|--------------------|------------------|
| SAT 24 | 4:29 AM CET/1.95M | 11:42 AM CET/0.28M | 4:44PM CET/1.89M | | |
| SUN 25 | | 12:00 AM CET/0.11M | 5:12AM CET/1.95M | 12:29 PM CET/0.21M | 5:30PM CET/1.97M |
| MON 26 | | 12:54 AM CET/0.10M | 5:54AM CET/1.91M | 1:15 PM CET/0.16M | 6:16PM CET/2.01M |
| TUE 27 | | 1:45 AM CET/0.13M | 6:36AM CET/1.84M | 1:59 AM CET/0.12M | 7:03PM CET/2.00M |
| WEN 28 | | 2:35AM CET/0.19M | 7:18AM CET/1.75M | 2:44AM CET/0.11M | 7:51PM CET/1.94M |

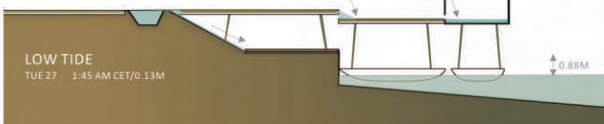

LOW TIDE
TUE 27 1:45 AM CET/0.13M



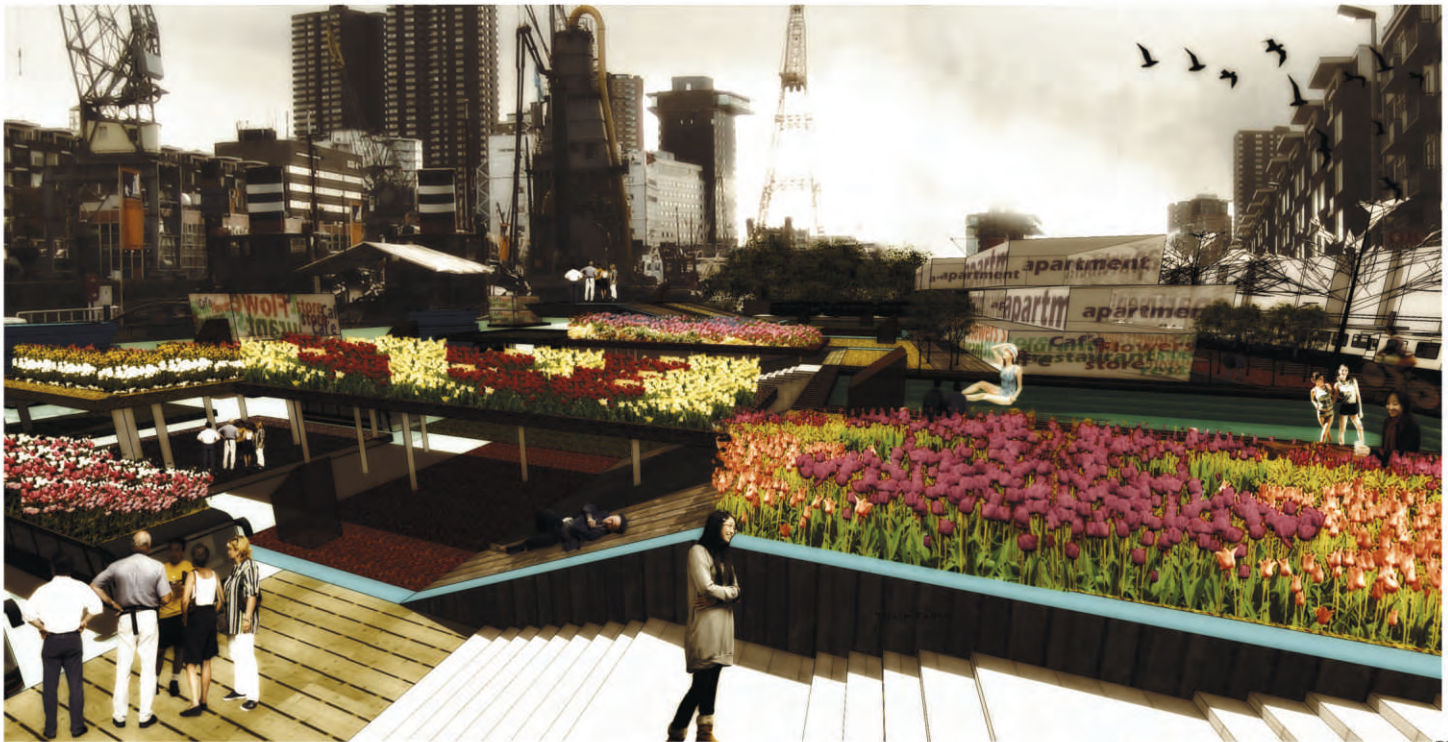
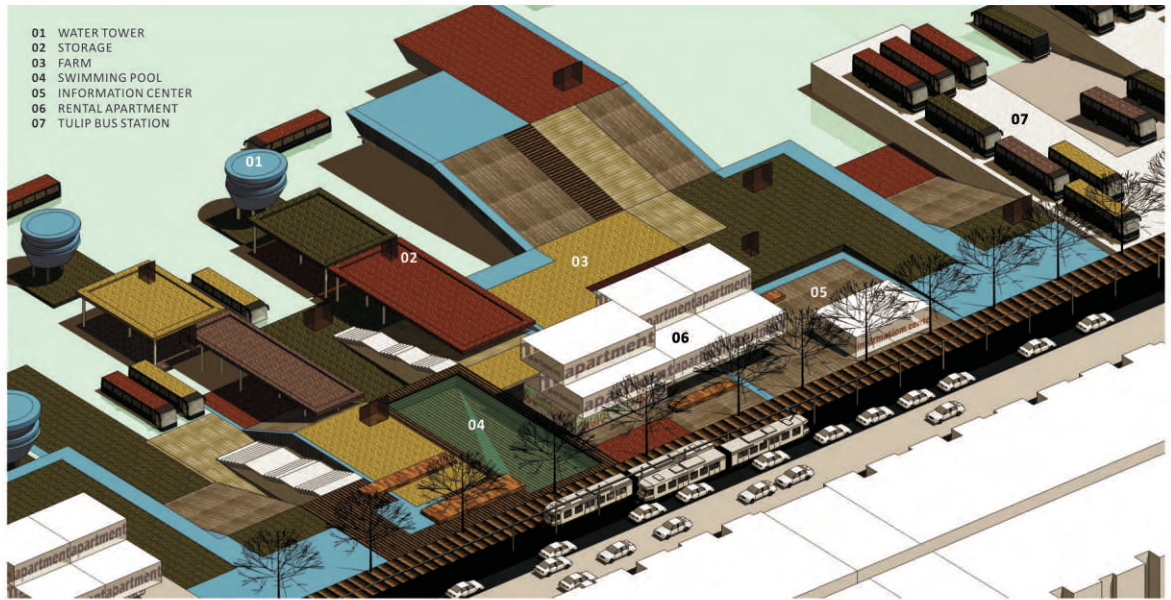



Window

Location: Taipei

Theme: Post-Document Art Exhibition

Organizer: Open-Contemporary Art Center

2006, December 10 - December 31





INTRODUCTION

The relationship between a window and a building: a viewer can look outside the window or s/he can look through the window from the outside. A window is an interior as well as exterior element in architecture. through reading the fragmented space behind the windows, we could rebuild the space in our mind.

Panels of highly reflective material are attached to French windows by the corridor at Huashan Culture Park. people can no longer see through these "windows." Instead, they mirror nearby environment on these panels that can flip with the wind. The environment is rearranged on these "windows", and its reflections change as time move forward.



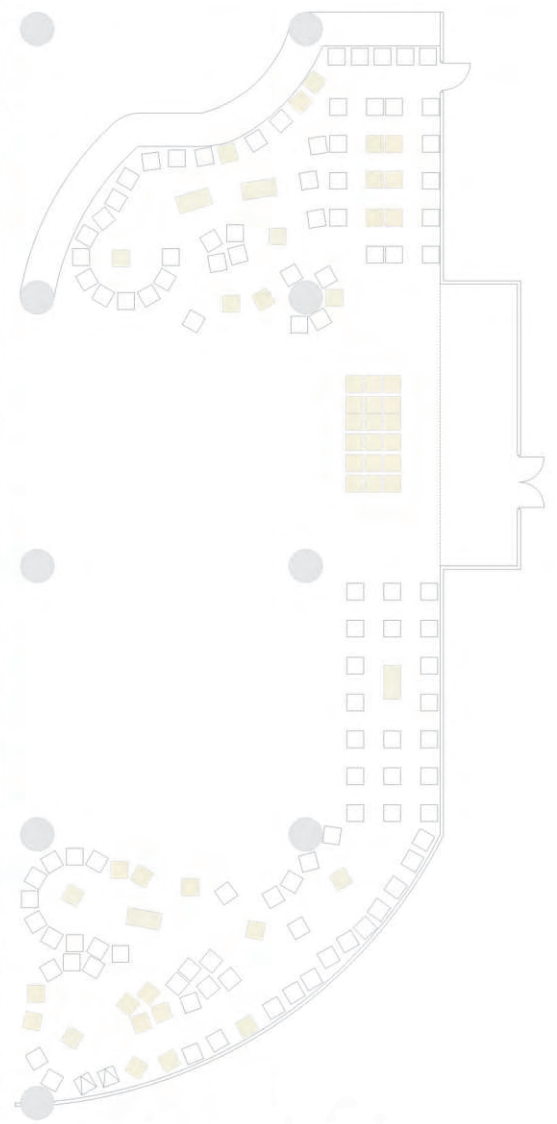

Knowledge Territory

Location: Shinchu

Theme: NextGEN Library: Digital Library for the Future

Organizer: Graduate Institute of Architecture, NCTU

2006, March 03 - April 02



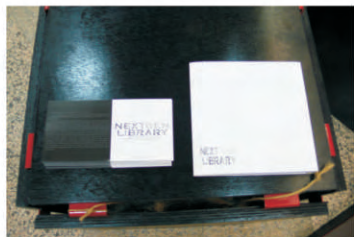

INTRODUCTION

這是一個NextGEN Library Studio與交通大學浩然圖書館合作的展覽，在一個傳統圖書館的大廳展出對次世代圖書館的想像，是一個有趣的對應關係。我們資訊由於數位資訊的普及，改變了單一線性，由獲得多重的連結，開始以一種超越的建構，而我們亦得同時面對龐大而能多的分類，資料群，進而從中尋找需要的訊息，這種較為隨機、游離、不固定的尋找及選定方式成為這次展覽場的主要概念。將一頁展本已經編製成爲一張張能夠獨自敘述的展示內容海報，何產式內容，海報在展場是以各自分佈，參觀者不需按照特定的行走動線觀看展場內容，而是一種較為隨機、或蹲或站的方式遊覽。

