

3-D PRACTICE OF CALLIGRAPHY

The composition of Calligraphy art is related to the conformation of brushes. The variation and characteristics of this art are formed in two ways: one is the different speeds to raise up and press down the brush on the paper and the other are three moving points on the tip and two sides of the brush-pen.

Regarding the tip and two sides of the brush-pen as a set of

Relative moving points in space, and release the moving traces into the three-dimensional models in the digital environment.

There is no absolute form of expression and the only way to pursue the personal artistic style is practicing. This design instance the running script of the Calligraphy to practice forty strokes of Chinese character in space.

WHAT IS CHARACTER OF ARCHITECTURE IN TAIPEI CITY ?

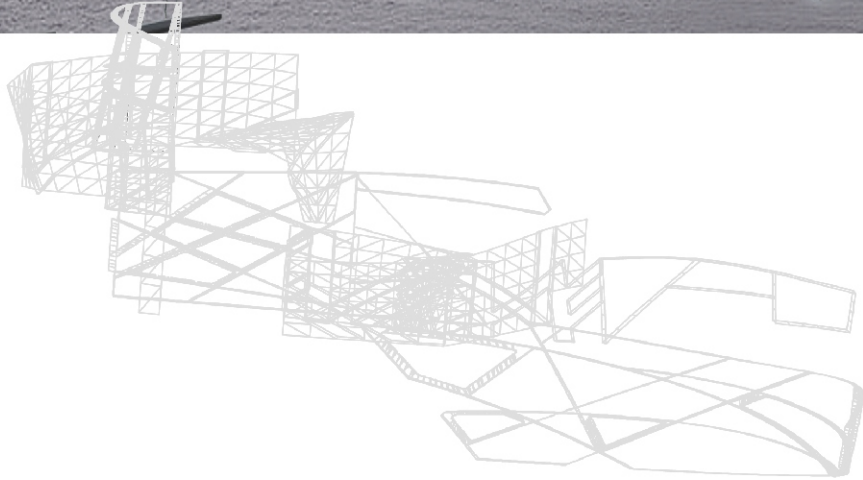

MOVIE THERTER

FORMOSA INTERNATIONAL HOTEL

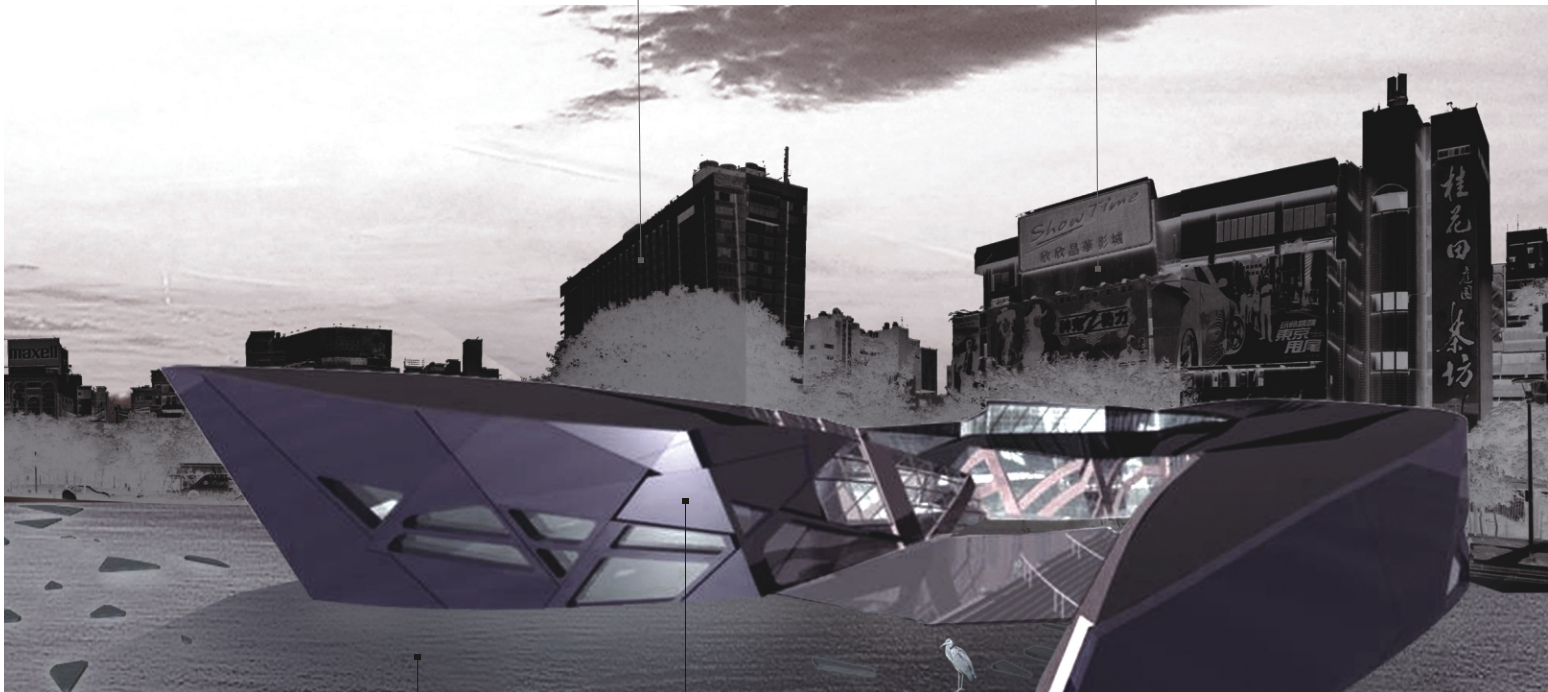

CHINA CALLIGRAPHY CAMPUS

TAIPEI 14TH. PARK